



Bertrange, le 10 novembre 2022

FICHE DE RÉCEPTION UE PAR TYPE DE VÉHICULE
EU VEHICLE TYPE-APPROVAL CERTIFICATE

Communication concernant l'octroi/l'extension/le refus/le retrait de:

Communication concerning granting/extension/refusal/withdrawal of:

- **Réception UE par type de véhicule entier conformément au règlement (UE) 2018/858**
EU whole vehicle type-approval in accordance with Regulation (EU) 2018/858
- **Réception UE par type de véhicule entier avec exemptions pour nouvelles technologies ou nouveaux concepts conformément à l'article 39, paragraphe 2, du règlement (UE) 2018/858 autorisées par la Commission conformément à l'article 39, paragraphe 3, dudit règlement**
EU whole vehicle type-approval with exemptions for new technologies or concepts in accordance with Article 39(2) of Regulation (EU) 2018/858 authorised by the Commission in accordance with Article 39(3) thereof
- **Réception UE par type provisoire de véhicule entier avec exemptions pour nouvelles technologies ou nouveaux concepts conformément à l'article 39, paragraphe 2, du règlement (UE) 2018/858 dans l'attente de l'autorisation de la Commission conformément à l'article 39, paragraphe 4, dudit règlement. La validité de la réception UE par type est donc limitée au JJ/MM/AAAA**
Provisional EU whole vehicle type-approval with exemptions for new technologies or concepts in accordance with Article 39(2) of Regulation (EU) 2018/858 pending on the authorisation by the Commission in accordance with Article 39(4) thereof. The validity of the EU type-approval is thus limited to DD/MM/YYYY
- **Réception UE par type de véhicules produits en petites séries conformément à l'article 41 du règlement (UE) 2018/858**
EU type-approval of vehicles produced in small series in accordance with Article 41 of Regulation (EU) 2018/858
- **Réception nationale par type de véhicules produits en petites séries conformément à l'article 42 du règlement (UE) 2018/858**
National type-approval of vehicles produced in small series in accordance with Article 42 of Regulation (EU) 2018/858

d'un type de:

of a type of:

- **véhicule complet**
Complete vehicle
- **véhicule complété**
Completed vehicle
- **véhicule incomplet**
Incomplete vehicle
- **véhicule avec variantes complètes et incomplètes**
Vehicle with complete and incomplete variants
- **véhicule avec variantes complétées et incomplètes**
Vehicle with completed and incomplete variants

Numéro de la fiche de réception UE par type: e13*2018/858*00339*02

Number of the EU type-approval certificate:

Raison de l'extension/du refus/du retrait:

Reason for extension/refusal/withdrawal:

refer to Appendix 0 of test report

SECTION I

SECTION I

- 0.1. Marque (nom commercial du constructeur):** SKYWELL, SKYWORTH
Make (trade name of manufacturer):
- 0.2. Type:** NJL6470BEV500-1
Type:
- 0.2.1. Dénomination(s) commerciale(s):** ET5, BE11
Commercial name(s):
- 0.3. Moyens d'identification du type, s'ils sont marqués sur le véhicule:** VIN
Means of identification of type, if marked on the vehicle:
- 0.3.1. Emplacement de ce marquage:** on floor frame under passenger seat, on statutory plate, on the upper left of dashboard
Location of that marking:
- 0.4. Catégorie de véhicule:** M₁
Category of vehicle:
- 0.5. Raison sociale et adresse du constructeur du véhicule ~~incomplet~~/complet/complété:** Nanjing Golden Dragon Bus Co., Ltd.
Company name and address of manufacturer of the ~~incomplete~~/complete/completed vehicle: No. 369, Binhuai Street, Zhetang Town, Lishui District, Nanjing City, Jiangsu Province, 211200, China
- 0.5.1 Dans le cas de véhicules réceptionnés en plusieurs étapes, raison sociale et adresse du constructeur du véhicule de base/du véhicule au(x) stade(s) antérieur(s):** not applicable
For multi-stage approved vehicles, company name and address of the manufacturer of the base/previous stage(s) vehicle:
- 0.8. Nom et adresse de l'atelier/des ateliers de montage:** Nanjing Golden Dragon Bus Co., Ltd.
Name(s) and address(es) of assembly plant(s): No. 369, Binhuai Street, Zhetang Town, Lishui District, Nanjing City, Jiangsu Province, 211200, China
- 0.9. Nom et adresse du mandataire du constructeur (le cas échéant):** BIO AUTO SP. Z O.O.
Name and address of the manufacturer's representative (if any): 30-015 Krakow, Świętokrzyska str, 12/323 Poland

SECTION II

SECTION II

- 1. Service technique responsable de la réalisation des essais:** TÜV Rheinland Luxemburg GmbH s.à r.l.
Technical service responsible for carrying out the tests:
- 2. Date du rapport d'essai:** 19.10.2022
Date of test report:
- 3. Numéro du rapport d'essai:** 87-2018/858-1498/22-00
Number of test report:

Je soussigné, certifie par la présente l'exactitude de la description du constructeur dans la fiche de renseignements en annexe relative au(x) véhicule(s) décrit(s) ci-dessus [un (des) échantillon(s) ayant été choisi(s) par les autorités compétentes en matière de réception UE par type et présenté(s) par le constructeur en tant que prototype(s) du type de véhicule], ainsi que l'applicabilité au type du véhicule des résultats d'essai en annexe.

The undersigned hereby certifies the accuracy of the manufacturer's description in the attached information document of the vehicle(s) described above, ((a) sample(s) having been selected by the EU type-approval authority and submitted by the manufacturer as prototype(s) of the vehicle type), and that the attached test results are applicable to the vehicle type.

1. Véhicules/variantes complets/complètes et complété(e)s:

For complete and completed vehicles/variants:

Le type de véhicule satisfait/ne satisfait pas aux prescriptions techniques de tous les actes réglementaires pertinents visés dans l'annexe II du règlement (UE) 2018/858.

The vehicle type meets/does not meet the technical requirements of all the relevant regulatory acts referred to in Annex II to Regulation (EU) 2018/858.

2. Véhicules/variantes incomplets/incomplètes:

For incomplete vehicles/variants:

Le type de véhicule satisfait/ne satisfait pas aux prescriptions techniques des actes réglementaires énumérés dans le tableau de la partie 2 de la présente fiche.

The vehicle type meets/does not meet the technical requirements of the regulatory acts listed in the table in part 2 of this certificate.

Lieu:

Place:

Bertrange

Signature:

Signature:

**Pour le Ministre de la Mobilité
et des Travaux publics**



**Alain DISIVISCOUR
Conseiller**

Pour la SNCH

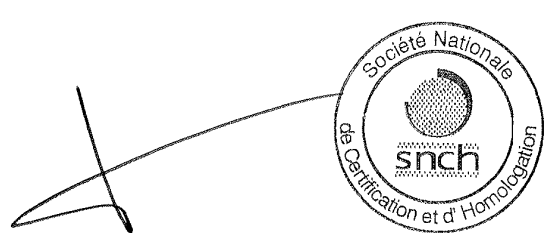

**Luc SCHMITT
Directeur QRM**



Date:

Date:

10 novembre 2022

Pièces jointes:

Attachments:

- Dossier d'information.
Information package.
- Fiche des résultats d'essai conformément au modèle figurant dans l'annexe VI du présent règlement.
Test results sheet in accordance with the template set out in Annex VI of this Regulation.
- Nom(s) et spécimen(s) de la signature de la (des) personne(s) habilitée(s) à signer les certificats de conformité, ainsi qu'une indication de sa (leur) fonction dans l'entreprise.
Name(s) and specimen(s) of the signature(s) of the person(s) authorised to sign certificates of conformity and a statement of their position in the company.
- ~~Fichier contenant les informations visées à l'article 39, paragraphe 2, du règlement (UE) 2018/858.~~
~~File containing the information referred to in paragraph 2 of Article 39 of Regulation (EU) 2018/858.~~

FICHE DE RECEPTION UE PAR TYPE DE VEHICULE
EU VEHICLE TYPE-APPROVAL CERTIFICATE

Partie 2

Part 2

La présente réception UE par type est fondée, pour les véhicules, variantes ou versions incomplets et complétés, sur la ou les réceptions de véhicules incomplets visées ci-dessous:

This EC type-approval is, where incomplete and completed vehicles, variants or versions are concerned, based on the approval(s) for incomplete vehicles listed below:

Etape 1: Constructeur du véhicule de base:

Stage 1: Manufacturer of the base vehicle: not applicable

Numéro de la fiche de réception UE par type:

Number of the EU type-approval: not applicable

Date:

Dated: not applicable

Applicable aux variantes ou versions (selon le cas):

Applicable to variants or versions (as appropriate): not applicable

Etape 2: Constructeur:

Stage 2: Manufacturer: not applicable

Numéro de la fiche de réception UE par type:

Number of the EU type-approval: not applicable

Date:

Dated: not applicable

Applicable aux variantes ou versions (selon le cas):

Applicable to variants or versions (as appropriate): not applicable

Etape 3: Constructeur:

Stage 3: Manufacturer: not applicable

Numéro de la fiche de réception UE par type:

Number of the EU type-approval: not applicable

Date:

Dated: not applicable

Applicable aux variantes ou versions (selon le cas):

Applicable to variants or versions (as appropriate): not applicable

Lorsque la réception inclut une ou plusieurs variantes ou versions (selon le cas) incomplètes, énumérer les variantes ou versions (selon le cas) complètes ou complétées:

In the case where the approval includes one or more incomplete variants or versions (as appropriate), list those variants or versions (as appropriate) which are complete or completed:

Variante(s) complète(s)/complétée(s):

Complete/completed variant(s): not applicable

Liste des prescriptions applicables au type de véhicule incomplet ou à la variante ou version (selon le cas) incomplète réceptionné(e) (compte tenu, le cas échéant, du champ d'application et de la dernière modification de chacun des actes réglementaires visés ci-dessous):

List of requirements applicable to the approved incomplete vehicle type, variant or version (as appropriate, taking account of the scope and latest amendment to each of the regulatory acts listed below):

Elément Item	Objet Subject	Référence de l'acte réglementaire Regulatory act reference	Dernière modification Last amended	Applicable à la variante ou, le cas échéant, à la version Applicable to variant or, if need be, to version
not applicable				

(N'indiquer que les objets pour lesquels il existe une réception UE par type.)

(List only subjects for which an EU type-approval exists.)

Dans le cas des véhicules à usage spécial, dérogations accordées ou dispositions spécifiques appliquées en vertu de l'annexe II, partie III, du règlement (UE) 2018/858, dérogations accordées en vertu de l'article 39 du règlement (UE) 2018/858 et dérogations accordées en vertu de l'article 42 du règlement (UE) 2018/858:

In the case of special purpose vehicles, exemptions granted or special provisions applied pursuant to Part III of Annex II to Regulation (EU) 2018/858, exemptions granted pursuant to Article 39 of Regulation (EU) 2018/858, and exemptions granted pursuant to Article 42 of Regulation (EU) 2018/858:

Elément Item	Objet Subject	Référence de l'acte réglementaire Regulatory act reference	Type de réception et nature de la dérogation Kind of approval and nature of exemption	Applicable à la variante ou, le cas échéant, à la version Applicable to variant or, if need be, to version
not applicable				

Appendice

Appendix

Liste des actes réglementaires auxquels le type de véhicule est conforme

List of regulatory acts to which the type of vehicle complies.

(à remplir uniquement en cas de réception par type d'un véhicule entier conformément à l'article 22, paragraphe 1, points b) et c), du règlement (UE) 2018/858)

(to be filled in only in the case of a whole-vehicle type-approval in accordance with Article 22(1)(b) and (c) of Regulation (EU) 2018/858)

Élément Item	Objet Subject	Référence de l'acte réglementaire Regulatory act reference	Modifié par As amended by	Applicable à la variante ou, le cas échéant, à la version Applicable to variant or, if need be, to version
<u>refer to Part III of information document</u>				



Bertrange, le 10 novembre 2022

Index du dossier de réception

Index to type-approval report

	Numéro de la fiche de réception UE par type: Number of the EU type-approval certificate:	e13*2018/858*00339*02
	Révision: Revision:	00
	Marque (nom commercial du constructeur): Make (trade name of manufacturer):	SKYWELL, SKYWORTH
	Type: Type:	NJL6470BEV500-1
1.	Rapport d'essai: Test report:	87-2018/858-1498/22-00
	- Test report:	Page 1 to 4
	- List of modifications:	Appendix 0 - Page 5
	- Test results sheet:	Appendix 1 - Page 6 to 15
2.	Dossier du constructeur: Report of the manufacturer:	No.: NJL6470BEV500-1-2018/858-02
	- Information folder:	<u>Page 1 to 40</u>
3.	Autres documents annexés: Other documents annexed:	not applicable
4.	Date de délivrance de la réception initiale: Date of issue of initial type-approval:	20.05.2022
5.	Date de la dernière délivrance de pages révisées: Date of last issue of revised pages:	not applicable
6.	Date de la dernière délivrance d'une réception révisée: Date of last extension:	10.11.2022



Référence: e13*2018/858*00339*02

Bertrange, le 10 novembre 2022

ANNEXE VI
ANNEX VI

FICHE DE RESULTATS D'ESSAIS
TEST RESULTS SHEET

Il doit être indiqué clairement à quelle version et à quelle variante le résultat d'essais s'applique. Pour chaque version, il ne peut y avoir qu'un seul résultat d'essais. Il est toutefois possible de combiner, pour chaque version, plusieurs résultats correspondant à la situation la moins avantageuse. Dans ce cas, une note indiquera que, pour les éléments accompagnés du signe (*), seuls les résultats les plus défavorables sont indiqués.
Please indicate clearly to which variant and version of the vehicle the test result applies. Each version shall not have more than one test result. In the case of several test results per version indicating the worst test result, a note shall state that for items marked (*) the worst test results are provided.

- | | | |
|----|---|---|
| 1. | Résultats des essais de niveau sonore
Results of the sound level test | <u>refer to Appendix 1 of test report</u> |
| 2. | Résultats des essais d'émission de gaz d'échappement
Results of the exhaust emission tests | not applicable |
| 3. | Résultats des essais d'émissions de CO₂, de consommation de carburant/d'énergie électrique et d'autonomie en mode électrique
Results of the CO ₂ emission, fuel/electric energy consumption, and electric range tests | <u>refer to Appendix 1 of test report</u> |
| 4. | Résultats des essais pour les véhicules équipés d'éco-innovations
Results of the tests for vehicles fitted with eco-innovation(s) | not applicable |

Test Report No. 87-2018/858-1498/22-00

Vehicle type : NJL6470BEV500-1

Manufacturer : Nanjing Golden Dragon Bus Co., Ltd.

TEST REPORT

According to the European Parliament / Council / Regulation (EU) 2018/858 on the approval and market surveillance of motor vehicles and their trailers

as last amended by Delegated Regulation (EU) 2021/1445

Implementing Regulation (EU) 2020/683

as last amended by

Regulation (EU) No. 2022/1362

Approval Status

EU type-approval : e13*2018/858*00339*01

Structure of the test report

Item No.

0. General Information
 1. Test vehicle(s) / object(s)
 2. Test record
 3. Remark concerning extension
 4. Appendices
 5. Statement of conformity
-

The Test Report shall be reproduced and published only in its entirety by the client. It may however be reproduced and published partially, but only with the written permission of the Technical Service.

Test Report No. 87-2018/858-1498/22-00**Vehicle type : NJL6470BEV500-1****Manufacturer : Nanjing Golden Dragon Bus Co., Ltd.****0. General information**

- 0.1. Make (trade name of manufacturer) : SKYWELL, SKYWORTH
- 0.2. Type : NJL6470BEV500-1
- 0.3. Category of vehicle : M1
- 0.4. Name and address of manufacturer : Nanjing Golden Dragon Bus Co., Ltd.
No. 369, Binhuai Street, Zhetang Town, Lishui District,
Nanjing City, Jiangsu Province, 211200, China
- 0.5. No. of information folder and date issued : NJL6470BEV500-1-2018/858-00, May 06, 2022
NJL6470BEV500-1-2018/858-01, July 15, 2022
NJL6470BEV500-1-2018/858-02, October 19, 2022

1. Test vehicle(s) / object(s)

1.1. Description

1.1.1. Vehicle / object

- Trade name : SKYWELL, SKYWORTH
- Type(s) / variant(s) / version(s) : NJL6470BEV500-1 / BET1 / AAAA5A, BAAB5A
- Identification number : See test reports to the separate regulation acts

1.1.2. Condition of vehicle(s)/object(s) : New, ~~used~~, ~~pre-tested~~

1.2. Worst case configuration : There is no worst case selection applicable because all versions mentioned in the information folder are tested.

1.3. Remark : --

Test Report No. 87-2018/858-1498/22-00**Vehicle type : NJL6470BEV500-1****Manufacturer : Nanjing Golden Dragon Bus Co., Ltd.**

e13*2018/858*00339*02

2. Test record

Société Nationale de Certification et d'Homologation

- 2.1. Equipment for measuring and testing : The test facilities / measurement equipment used were in compliance with the test requirements.
- 2.1.1. Specifications for the test site : Not applicable
- 2.1.2. Subcontracting : Not applicable
- 2.2. Test result
- 2.2.1. Verification according to Annex III, No. 2. a), Regulation (EU) No 2018/858 : The type-approval certificates issued pursuant to the regulatory acts in Annex II which are applicable for vehicle type-approval cover the vehicle type and correspond to the prescribed requirements.
- 2.2.2. Verification according to Annex III, No. 2. b), Regulation (EU) No 2018/858 : The vehicle specifications and data in the above mentioned information package are in compliance to those included in the information packages/approval certificates of the relevant regulatory acts.
- 2.2.3. Verification according to Annex III, No. 2. c), Regulation (EU) No 2018/858 : Not applicable
- 2.2.4. Verification according to Annex III, No. 2. d), Regulation (EU) No 2018/858 : The selected vehicles under 1.1 allow an appropriate examination of the various combinations according to the specifications listed under 3, annex III, Regulation (EU) No 2018/858.
- 2.2.5. Verification and installation check(s) according to Annex III, No. 2. e), Regulation (EU) No 2018/858 : Not applicable/ ~~Fulfilled~~
- 2.2.6. Verification and necessary check(s) according to Annex III, No. 2. f), Regulation (EU) No 2018/858 (in case of LPG or CNG vehicles) : Not applicable / ~~Fulfilled~~
- 2.2.7. Verification and necessary check(s) according to Annex III, No. 2.g), Regulation (EU) No 2018/858 (Categories M2, M3, N1, N2, N3 only) : Not applicable / ~~Fulfilled~~
- 2.3. Test site : CMVR, Chongqing, China
CMVR, Chongqing, China
CMVR, Chongqing, China
- 2.4. Test date : May 06, 2022
July 08, 2022
October 19, 2022
- 2.4. Remarks : --

Test Report No. 87-2018/858-1498/22-00

Vehicle type : NJL6470BEV500-1

Manufacturer : Nanjing Golden Dragon Bus Co., Ltd.

3. Remark concerning extension: The vehicle type has been tested according to the modification(s) mentioned in appendix 0.The new parts meet the requirements of the regulation.An actual practical test of the component was not necessary. The results of the previous test(s) are still valid.**4. Appendices**

- 0 List of modifications
- 1 Test Results according to Annex VI,
Regulation (EU) 2020/683
- Information folder

5. Statement of conformity

The Information Document listed in section 0.5., and the type described therein, comply with the requirements stated on page 1.

The test results in this report refer to the vehicle(s)/object(s) described under section 1.1.

With regards to the required level of performance to be achieved, the tested samples were representative for the type to be approved (see section 1.2).

Engineering centre Shanghai, October 19, 2022



Jerry Li
Technical Expert Technical Service

Test Report No. 87-2018/858-1498/22-00

Vehicle type : NJL6470BEV500-1

Manufacturer : Nanjing Golden Dragon Bus Co., Ltd.

List of modifications

Appendix 0

e13*2018/858*00339*02

Société Nationale de Certification et d'Homologation

Correction of : - --

Modification of : - part III list of information folder
- the amendment version to Regulation (EU) No. 2022/1362 from Regulation (EU) No. 2022/1177

Addition of : - one optional power battery;
- an optional brake assembly;
- one optional front bumper;
- one whole vehicle version

Deletion of : - --

Test Report No. 87-2018/858-1498/22-00**Vehicle type : NJL6470BEV500-1****Manufacturer : Nanjing Golden Dragon Bus Co., Ltd.****Test Results according to Annex VI****Appendix 1****TEST RESULTS SHEET**

(Information folder according to Commission Implementing Regulation (EU) 2020/683, as last amended by Regulation (EU) 2022/195)

Please indicate clearly to which variant and version of the vehicle the test result applies. Each version shall not have more than one test result. In the case of several test results per version indicating the worst test result, a note shall state that for items marked (*) the worst test results are provided.

1. Results of the sound level tests

Please provide the number of the regulatory act laying down the applicable requirements and the number of its latest amendment. Where the regulatory act provides for two or more implementation stages, please also indicate the implementation stage:

Variant/Version of the vehicle	BET1/AAAA5A, BAAB5A		
Moving (dB(A)/E)	67		
Stationary (dB(A)/E)			
At (min ⁻¹)			

2. Results of the exhaust emission tests**2.1. Emissions from motor vehicles tested under the test procedure for light-duty vehicles**

Please provide the number of the regulatory act laying down the applicable requirements or, where amended, the number of its latest amendment. Where the regulatory act provides for two or more implementation stages, please also indicate the implementation stage:

Regulation (EU) 2018/1832

Fuel(s) ⁽¹²⁸⁾ : ... (diesel, petrol, LPG, NG, Bi-fuel: petrol/NG, LPG, NG/biomethane, Flex-fuel: petrol/ethanol, ...) ^{(4) (129)}

2.1.1. Type 1 test ⁽¹³⁰⁾, ⁽¹³¹⁾ (vehicle emissions in the test cycle after a cold start)

NEDC average values, WLTP highest values

Variant/Version of the vehicle
CO (mg/km)
THC (mg/km)
NMHC (mg/km)
NO _x (mg/km)
THC + NO _x (mg/km)
Mass of particulate matter (PM) (mg/km) (if applicable)
Number of particles (PN) (#/km) (if applicable) ⁽³⁾

Test Report No. 87-2018/858-1498/22-00**Vehicle type : NJL6470BEV500-1****Manufacturer : Nanjing Golden Dragon Bus Co., Ltd.**

Ambient Temperature Correction Test (ATCT)

ATCT Family	Interpolation family
...	...
...	...

Family correction factors

ATCT Family	FCF
...	...
...	...

2.1.2. Type 2 test ⁽¹³⁰⁾, ⁽¹³¹⁾ (emissions data required at type-approval for roadworthiness purposes)

Type 2, low idle test:

Variant/Version of the vehicle
CO (% vol.)
Engine speed (min ⁻¹)
Engine oil temperature (°C)

Type 2, high idle test:

Variant/Version of the vehicle
CO (% vol.)
Lambda Value
Engine speed (min ⁻¹)
Engine oil temperature (°C)

2.1.3. Type 3 test (emissions of crankcase : Not applicable gases)

2.1.4. Type 4 test (evaporative emissions) : Not applicable

2.1.5. Type 5 test (durability of anti-pollution control devices):

– Ageing distance covered (km) : Not applicable
(e.g. 160 000 km)– Deterioration factor DF : ~~calculated~~/fixed ⁽¹⁾

– Values:

Variant/Version of the vehicle
CO
THC
NMHC
NO _x
THC + NO _x
Mass of particulate matter (PM) (mg/km) (if applicable)
Number of particles (PN) (#/km) (if applicable) ⁽³⁾

Test Report No. 87-2018/858-1498/22-00

Vehicle type : NJL6470BEV500-1

Manufacturer : Nanjing Golden Dragon Bus Co., Ltd.

2.1.6. Type 6 test (average emissions at low ambient temperatures):

Variant/Version of the vehicle
CO (g/km)
THC (g/km)

2.1.7. OBD : ~~yes~~/no⁽¹⁾

2.2. Emissions from engines tested under the test procedure for heavy-duty vehicles

Please provide the number of the regulatory act laying down the applicable requirements or, where amended, the number of its latest amendment. Where the regulatory act provides for two or more implementation stages, please also indicate the implementation stage:

...

Fuel(s)⁽¹²⁸⁾ : ... (~~diesel, petrol, LPG, NG, ethanol~~ ...)2.2.1. Results of the ESC test^{(132), (133), (134)}

Variant/Version of the vehicle
CO (mg/kWh)
THC (mg/kWh)
NO _x (mg/kWh)
NH ₃ (ppm) ⁽⁵⁾
PM mass (mg/kWh)
PM number (#/kWh) ⁽⁵⁾

2.2.2. Results of the ELR test⁽¹³²⁾

Variant/Version of the vehicle
Smoke value: (m ⁻¹)

2.2.3. Results of the ETC test^{(133), (134)}

Variant/Version of the vehicle
CO (mg/kWh)
THC (mg/kWh)
NMHC (mg/kWh) ⁽¹³²⁾
CH ₄ (mg/kWh) ⁽¹³²⁾
NO _x (mg/kWh)
NH ₃ (ppm) ⁽¹³²⁾
PM mass (mg/kWh)
PM number (#/kWh) ⁽¹³²⁾

2.2.4. Idle test⁽¹³²⁾

Variant/Version of the vehicle
CO (% vol.)
Lambda value ⁽¹³²⁾
Engine speed (min ⁻¹)
Engine oil temperature (K)

Test Report No. 87-2018/858-1498/22-00**Vehicle type : NJL6470BEV500-1****Manufacturer : Nanjing Golden Dragon Bus Co., Ltd.****2.3. Diesel smoke:**

Please provide the number of the regulatory act laying down the applicable requirements or, where amended, the number of its latest amendment. Where the regulatory act provides for two or more implementation stages, please also indicate the implementation stage:

...

2.3.1. Results of the test under free acceleration:

Variant/Version of the vehicle
Corrected value of the absorption coefficient (m ⁻¹)
Normal engine idling speed
Maximum engine speed
Oil temperature (min./max.)

3. Results of the CO₂ emission, fuel/electric energy consumption, and electric range tests

Please provide the number of the regulatory act laying down the applicable requirements or, where amended, the number of its latest amendment:

Base regulatory act: Regulation (EC) No 715/2007 i.c.w. Regulation (EC) 2017/1151 as last amended by Regulation (EU) 2018/1832.

3.1. Internal combustion engines, including not externally chargeable hybrid electric vehicles (NOVC) ⁽¹³²⁾ ⁽¹³⁵⁾

Variant/Version of the vehicle
CO ₂ mass emission (urban conditions) (g/km)
CO ₂ mass emission (extra-urban conditions) (g/km)
CO ₂ mass emission (combined) (g/km)
Fuel consumption (urban conditions) (l/100 km) ⁽¹³⁶⁾
Fuel consumption (extra-urban conditions) (l/100 km) ⁽¹³⁶⁾
Fuel consumption (combined) (l/100 km) ⁽¹³⁶⁾

Interpolation family identifier ⁽¹³⁷⁾	Variant/versions
...	...
...	...
...	...

Test Report No. 87-2018/858-1498/22-00**Vehicle type : NJL6470BEV500-1****Manufacturer : Nanjing Golden Dragon Bus Co., Ltd.**

Results	Interpolation family identifier		
	VH	VM ⁽¹³²⁾	VL ⁽¹³²⁾
CO ₂ mass emission LOW phase (g/km)
CO ₂ mass emission MID phase (g/km)
CO ₂ mass emission HIGH phase (g/km)
CO ₂ mass emission EXTRA HIGH phase (g/km)
CO ₂ mass emission (combined) (g/km)
Fuel consumption LOW phase (l/100 km m ³ /100 km kg/100 km)
Fuel consumption MID phase (l/100 km m ³ /100 km kg/100 km)
Fuel consumption HIGH phase (l/100 km m ³ /100 km kg/100 km)
Fuel consumption EXTRA HIGH phase (l/100 km m ³ /100 km kg/100 km)
Fuel consumption (combined) (l/100 km m ³ /100 km kg/100 km)
f ₀ (N)
f ₁ (N/(km/h))
f ₂ (N/(km/h))
RR (kg/t)
Delta Cd*A (for VL if applicable compared to VH)
Test Mass (kg)
Frontal area (m ²) (for road load matrix family vehicles only)

Repeat for each interpolation family.

3.2. Externally chargeable hybrid electric vehicles (OVC) ⁽¹³²⁾

Variant/Version of the vehicle
CO ₂ mass emission (Condition A, combined) (g/km)
CO ₂ mass emission (Condition B, combined) (g/km)
CO ₂ mass emission (weighted, combined) (g/km)
Fuel consumption (Condition A, combined) (l/100 km) ⁽⁹⁾
Fuel consumption (Condition B, combined) (l/100 km) ⁽⁹⁾
Fuel consumption (weighted, combined) (l/100 km) ⁽⁹⁾
Electric energy consumption (Condition A, combined) (Wh/km)
Electric energy consumption (Condition B, combined) (Wh/km)
Electric energy consumption (weighted and combined) (Wh/km)
Pure electric range (km)

Test Report No. 87-2018/858-1498/22-00

Vehicle type : NJL6470BEV500-1

Manufacturer : Nanjing Golden Dragon Bus Co., Ltd.

Interpolation family number	Variant/versions
...	...
...	...
...	...

Results	Interpolation family identifier		
	VH	VM ⁽¹³²⁾	VL ⁽¹³²⁾
CS CO ₂ mass emission LOW phase (g/km)
CS CO ₂ mass emission MID phase (g/km)
CS CO ₂ mass emission HIGH phase (g/km)
CS CO ₂ mass emission EXTRA-HIGH phase (g/km)
CS CO ₂ mass emission (combined) (g/km)
CD CO ₂ mass emission (combined) (g/km)
CO ₂ mass emission (weighted, combined) (g/km)
CS Fuel consumption LOW phase (l/100 km)
CS Fuel consumption MID phase (l/100 km)
CS Fuel consumption HIGH phase (l/100 km)
CS Fuel consumption EXTRA-HIGH phase (l/100 km)
CS Fuel consumption (combined) (l/100 km)
CD Fuel consumption (combined) (l/100 km)
Fuel consumption (weighted, combined) (l/100 km)
EC _{AC,weighted}
EAER (combined)
EAER _{city}
f ₀ (N)
f ₁ (N/(km/h))
f ₂ (N/(km/h))
RR (kg/t)
Delta Cd*A (for VL or VM compared to VH)
Test Mass (kg)
Frontal area (m ²) (for road load matrix family vehicles only)

Repeat for each interpolation family

3.3. Pure electric vehicles ⁽¹³²⁾

Variant/Version of the vehicle	BET1/AAAA5A	BET1/BAAB5A	...
Electric energy consumption (Wh/km)	193.0	<u>198.3</u>	...
Range (km)	400.0	<u>489.0</u>	...

Interpolation family number	Variant/versions
IP-AL1A1111-LME-1	BET1/AAAA5A
<u>IP-AL2A1111-LME-1</u>	<u>BET1/BAAB5A</u>
...	...

Test Report No. 87-2018/858-1498/22-00

Vehicle type : NJL6470BEV500-1

Manufacturer : Nanjing Golden Dragon Bus Co., Ltd.

Results	Interpolation family identifier		
	VH		VL
	Version: AAAA5A	Version: BAAB5A	
Electric Consumption (Combined) (Wh/km)	193	198	...
Pure Electric Range (Combined) (km)	400	489	...
Pure Electric Range (City) (km)	456	646	...
f_0 (N)	194.2	250.3	...
f_1 (N/(km/h))	0.187	-0.493	...
f_2 (N/(km/h))	0.04222	0.04528	...
RR (kg/t)	7.08	7.08	...
Delta Cd*A (for VL compared to VH)	Not applicable	Not applicable	...
Test Mass (kg)	2021.3	2071.3	...
Frontal area (m ²) (for road load matrix family vehicles only)	Not applicable	Not applicable	...

3.4. Hydrogen fuel cell vehicles ⁽¹³²⁾

Variant/Version of the vehicle
Fuel consumption (kg/100 km)
	Variant/Version		Variant/Version
Fuel Consumption (Combined) (kg/100 km)
f_0 (N)
f_1 (N/(km/h))
f_2 (N/(km/h))
RR (kg/t)
Test Mass (kg)

3.5. The Correlation Tool Output Report(s) referred to in Commission Implementing Regulation (EU) 2017/1152⁽¹³⁸⁾ or Commission Implementing Regulation (EC) No. 2017/1153⁽¹³⁹⁾, and Final NEDC Values

e13*2018/858*00339*02

Repeat for each interpolation family : ... Société Nationale de Certification et d'Homologation

Interpolation family identifier⁽¹⁴⁰⁾ : ...

VH report : ...

VL report (if applicable) : ...

3.5.1. Deviation factor (if applicable) : ...

Repeat for each interpolation family : ...

Interpolation family identifier : ...

3.5.2. Verification factor (if applicable)

Repeat for each interpolation family : ...

Interpolation family identifier : ...

Test Report No. 87-2018/858-1498/22-00**Vehicle type : NJL6470BEV500-1****Manufacturer : Nanjing Golden Dragon Bus Co., Ltd.**
3.5.3. Internal Combustion Engines, including Not Externally Chargeable Hybrid Electric Vehicles (NOVC)⁽¹⁴¹⁾⁽¹³⁵⁾

Final correlated NEDC values	Interpolation family identifier	
	VH	VL
CO ₂ mass emission (urban conditions) (g/km)
CO ₂ mass emission (extra-urban conditions) (g/km)
CO ₂ mass emission (combined) (g/km)
Fuel consumption (urban conditions) (l/100km) ⁽¹³²⁾
Fuel consumption (extra-urban conditions) (l/100km) ⁽¹³²⁾
Fuel consumption (combined) (l/100km) ⁽¹³²⁾

3.5.4. Externally Chargeable Hybrid Electric Vehicles (OVC)⁽¹³²⁾

Final correlated NEDC values	Interpolation family identifier	
	VH	VL
CO ₂ mass emission (weighted, combined) (g/km)
Fuel consumption (weighted, combined) (l/100km)

4. Results of the tests for vehicles fitted with eco-innovation(s)^{(141) (135) (142)}
According to Regulation 83⁽¹⁴³⁾ (if applicable)

Variant/Version: ...								
Decision approving the eco-innovation ⁽¹⁴⁴⁾	Code of the eco-innovation ⁽¹⁴⁵⁾	Type 1/l cycle (NEDC/WLTP)	1. CO ₂ emissions of the baseline vehicle (g/km)	2. CO ₂ emissions of the eco-innovation vehicle (g/km)	3. CO ₂ emissions of the baseline vehicle under Type 1 test-cycle ⁽¹⁴⁶⁾	4. CO ₂ emissions of the eco-innovation vehicle under Type 1 test-cycle ⁽¹⁴⁷⁾	5. Usage factor (UF) i.e. temporal share of technology usage in normal operation conditions	CO ₂ emissions savings ((1 - 2) - (3 - 4)) * 5
xxx/201x
...
...
Total CO ₂ emissions savings on NEDC (g/km) ⁽¹⁴⁸⁾								...

Test Report No. 87-2018/858-1498/22-00**Vehicle type : NJL6470BEV500-1****Manufacturer : Nanjing Golden Dragon Bus Co., Ltd.**

Test conducted as required by Annex XXI to Commission Regulation (EU) 2017/1151⁽¹⁴⁹⁾
(where applicable)

Decision approving the eco-innovation ⁽¹⁴⁴⁾	Variant/Version: ...							
	Code of the eco-innovation ⁽¹⁴⁵⁾	Type 1/l cycle (NEDC/WLTP)	1. CO ₂ emissions of the baseline vehicle (g/km)	2. CO ₂ emissions of the eco-innovation vehicle (g/km)	3. CO ₂ emissions of the baseline vehicle under Type 1 test-cycle ⁽¹⁴⁶⁾	4. CO ₂ emissions of the eco-innovation vehicle under Type 1 test-cycle	5. Usage factor (UF) i.e. temporal share of technology usage in normal operation conditions	CO ₂ emissions savings ((1 - 2) - (3 - 4)) * 5
xxx/201x
...
...
Total CO ₂ emissions savings on WLTP (g/km) ⁽¹⁵⁰⁾								...

4.1. General code of the eco-innovation(s)⁽¹⁵¹⁾ : Not applicable

Explanatory notes

⁽¹²⁸⁾ When restrictions for the fuel are applicable, indicate those restrictions (e.g. for natural gas the L range or the H range).

⁽⁴⁾ Delete where not applicable (there are cases where nothing needs to be deleted when more than one entry is applicable).

⁽¹²⁹⁾ Vehicles can be fuelled with both petrol and a gaseous fuel but, where the petrol system is fitted for emergency purposes or starting only and of which the petrol tank cannot contain more than 15 litres of petrol, will be regarded for the test as vehicles which can only run a gaseous fuel.

⁽¹³⁰⁾ For bi fuel vehicles, the table shall be repeated for both fuels.

⁽¹³¹⁾ For flex fuel vehicles, when the test is to be performed on both fuels, as required by Figure I.2.4 of Annex I to Commission Regulation (EU) 2017/1151. For vehicles running on LPG or NG/Biomethane, either bi-fuel or mono-fuel, the table shall be repeated for the different reference gases used in the test, and an additional table shall display the worst results obtained in accordance with [When required by?] paragraph 3.1.4. of Annex 12 to UN Regulation No 83 of the Economic Commission for Europe of the United Nations (UN/ECE) — Uniform provisions concerning the approval of vehicles with regard to the emission of pollutants according to engine fuel requirements (OJ L 42, 15.2.2012, p. 1). The results in the table shall be indicated if they are measured or calculated.

⁽¹³²⁾ If applicable.

⁽¹³³⁾ For Euro VI, ESC shall be understood as WHSC and ETC as WHTC.

⁽¹³⁴⁾ For Euro VI, if CNG and LPG fuelled engines are tested on different reference fuels, the table shall be reproduced for each reference fuel tested.

⁽¹³⁵⁾ Repeat the table for each reference fuel tested.

⁽¹³⁶⁾ The unit 'l/100km' is replaced by 'm³/100km' for vehicles fuelled with NG and H₂NG, and by 'kg/100km' for vehicles fuelled with hydrogen.

⁽¹³⁷⁾ The format for the Interpolation Family Identifier is provided in paragraph 5.0 of Annex XXI to Commission Regulation (EU) 2017/1151 of 1 June 2017 supplementing Regulation (EC) No 715/2007 of the European Parliament and of the Council on type-approval of motor vehicles with respect to emissions from light passenger and commercial vehicles (Euro 5 and Euro 6) and on access to vehicle repair and maintenance information, amending Directive 2007/46/EC of the European Parliament and of the Council, Commission Regulation (EC) No 692/2008 and Commission Regulation (EU) No 1230/2012 and repealing Commission Regulation (EC) No 692/2008 (OJ L 175, 7.7.2017, p. 1).

⁽¹³⁸⁾ Commission Implementing Regulation (EU) 2017/1152 of 2 June 2017 setting out a methodology for determining the correlation parameters necessary for reflecting the change in the regulatory test procedure with regard to light commercial vehicles and amending Implementing Regulation (EU) No 293/2012 (OJ L 175, 7.7.2017, p. 644).

⁽¹³⁹⁾ Commission Implementing Regulation (EU) 2017/1153 of 2 June 2017 setting out a methodology for determining the correlation parameters necessary for reflecting the change in the regulatory test procedure and amending Regulation (EU) No 1014/2010 (OJ L 175, 7.7.2017, p. 679).

⁽¹⁴⁰⁾ The format for the Interpolation Family Identifier is provided in paragraph 5.0 of Annex XXI to Commission Regulation (EU) 2017/1151.

⁽¹⁴¹⁾ Repeat the table for each variant/version of the vehicle.

⁽¹⁴¹⁾ Repeat the table for each variant/version of the vehicle.

⁽¹⁴²⁾ Expand the table if necessary, using one extra row per eco-innovation.

⁽¹⁴³⁾ UN Regulation No 83 of the Economic Commission for Europe of the United Nations (UN/ECE) Uniform provisions concerning the approval of vehicles with regard to the emission of pollutants according to engine fuel requirements (OJ L 42, 15.2.2012, p. 1).

Test Report No. 87-2018/858-1498/22-00**Vehicle type : NJL6470BEV500-1****Manufacturer : Nanjing Golden Dragon Bus Co., Ltd.**

- ⁽¹⁴⁴⁾ Commission Decision approving the eco-innovation. Article 12 of Regulation (EC) No 443/2009 of the European Parliament and of the Council (OJ L 140, 5.6.2009, p.1).
- ⁽¹⁴⁵⁾ As assigned in the Commission Decision approving the eco-innovation.
- ⁽¹⁴⁶⁾ If a modelling methodology is applied instead of the type 1 test cycle, this value shall be the one provided by the modelling methodology.
- ⁽¹⁴⁷⁾ = point 3.5.1.3 of Annex I to Commission Implementing Regulation XX/XXX of on implementing Regulation (EU) 2018/858 of the European Parliament and of the Council with regards to the administrative requirements for the approval and market surveillance of motor vehicles and their trailers, and of systems, components and separate technical units intended for such vehicles
- ⁽¹⁴⁸⁾ Sum of the results from each individual eco-innovation CO2 emissions savings on NEDC calculated in the last Colom of this table in accordance with Annex XII to Commission Regulation (EU) 2017/1151.
- ⁽¹⁴⁹⁾ Commission Regulation (EU) 2017/1151 of 1 June 2017 supplementing Regulation (EC) No 715/2007 of the European Parliament and of the Council on type-approval of motor vehicles with respect to emissions from light passenger and commercial vehicles (Euro 5 and Euro 6) and on access to vehicle repair and maintenance information, amending Directive 2007/46/EC of the European Parliament and of the Council, Commission Regulation (EC) No 692/2008 and Commission Regulation (EU) No 1230/2012 and repealing Commission Regulation (EC) No 692/2008 (OJ L 175, 7.7.2017, p. 1).
- ⁽¹⁵⁰⁾ Sum of the results from each individual eco-innovation CO2 emissions savings on WLTP calculated in the last Colom of this table in accordance with Annex XII to Commission Regulation (EU) 2017/1151.
- ⁽¹⁵¹⁾ The general code of the eco-innovation(s) shall consist of the following elements, each separated by a blank space:
- The code of the approval authority set out in Annex IV to Commission Implementing Regulation XX/XXX of XXXX on implementing Regulation (EU) 2018/858 of the European Parliament and of the Council with regards to the administrative requirements for the approval and market surveillance of motor vehicles and their trailers, and of systems, components and separate technical units intended for such vehicles;
 - The individual code of each eco-innovation fitted in the vehicle, listed in chronological order of the Commission approval decisions. (E.g. the general code of three eco-innovations approved chronologically as 10, 15 and 16 and fitted into a vehicle certified by the German type-approval authority should be: 'e1 10 15 16').

e13*2018/858*00339*02

Société Nationale de Certification et d'Homologation

Manufacturer : Nanjing Golden Dragon Bus Co., Ltd.
 Type : NJL6470BEV500-1

e13*2018/858*00339*02

Société Nationale de Certification et d'Homologation

Application for Approval

Subject : WVTA

Applicable Regulatory Act : Regulation (EU) No. 2018/858

Amended by : Regulation (EU) No. 2021/1445

Extension	Reason for Extension / Revision	Date complete
00	Main report base approval	May 06, 2022
01	Add an optional type of TPMS Add an optional 11kW on-board charger Add an optional steering column Add information according to Regulation (EU) 2022/1177	July 15, 2022
02	<u>Addition of one optional power battery;</u> <u>Addition of optional brake assembly;</u> <u>Addition of one optional front bumper;</u> <u>Addition of one whole vehicle version;</u> <u>Modification of Part III list of information folder;</u> <u>Modification of the amendment version to Regulation (EU) No. 2022/1362 from Regulation (EU) No. 2022/1177.</u>	<u>October 19, 2022</u>

Content index

PART I	3
GENERAL	3
GENERAL CONSTRUCTION CHARACTERISTICS OF THE VEHICLE	4
MASSES AND DIMENSIONS (IN KG AND MM)	4
PROPULSION ENERGY CONVERTER	6
TRANSMISSION	6
AXLES	7
SUSPENSION	7
STEERING	8
BRAKES	8
BODYWORK	9
CONNECTIONS BETWEEN TOWING VEHICLES AND TRAILERS AND SEMI-TRAILERS	11
MISCELLANEOUS	11
SPECIAL PROVISIONS FOR BUSES AND COACHES	13
ACCESS TO VEHICLE REPAIR AND MAINTENANCE INFORMATION	13
AUTOMATED DRIVING SYSTEM (ADS)	13
PART II Matrix showing the combinations of the entries listed in Part I within the versions and variants of the vehicle type ...	14
Part III	15
Annex 1 Vehicle Identification Number system	17
Annex 2 Manufacturer's plate	18
Annex 3 Views of the vehicle	19
Annex 4 Mass of the vehicle	20
Annex 5 Drawing of seat arrangement and R points	21
Annex 6 Location of statutory plate and VIN	22
Annex 7 Drawing of front suspension and front axle	23
Annex 8 Drawing of rear suspension and rear axle	25
Annex 9 Drawing of sketch of steering system	27
Annex 10 List of rear view mirror	29
Annex 11 Overview of the high voltage electric components arrangement and location on the vehicle	30
Annex 12 Drawing of the installation of the REESS in the vehicle	34
Annex 13 Name(s) and specimen(s) of the signature(s) of the person(s) authorized to sign CoC	36
Annex 14 CoC sample	37

e13*2018/858*00339*02

Société Nationale de Certification et d'Homologation

Manufacturer : Nanjing Golden Dragon Bus Co., Ltd.
 Type : NJL6470BEV500-1

e13*2018/858*00339*02

Société Nationale de Certification et d'Homologation

PART I
0.**GENERAL**

- | | | | |
|----------|---|---|--|
| 0.1. | Make (trade name of manufacturer) | : | SKYWELL, SKYWORTH |
| 0.2. | Type | : | NJL6470BEV500-1 |
| 0.2.1. | Commercial name(s) (if available) | : | ET5, BE11 |
| 0.2.2. | For multi-stage approved vehicles, type-approval information of the base / previous stage vehicle (list the information for each stage. This can be done with a matrix) | : | Not applicable |
| 0.2.3 | Identifiers | | |
| 0.2.3.1. | interpolation family's identifier: | : | Version AAAA5A: IP-AL1A1111-LME-1
<u>Version BAAB5A: IP-AL2A1111-LME-1</u> |
| 0.2.3.2. | ATCT family's identifier | : | Not applicable |
| 0.2.3.3. | PEMS family's identifier | : | Not applicable |
| 0.2.3.4. | Roadload family's identifier | : | Version AAAA5A: RL-AL1A1111-LME-1
<u>Version BAAB5A: RL-AL2A1111-LME-1</u> |
| 0.2.3.5. | Roadload Matrix family's identifier | : | Not applicable |
| 0.2.3.6. | Periodic regeneration family's identifier | : | Not applicable |
| 0.2.3.7. | Evaporative test family's identifier | : | Not applicable |
| 0.2.3.8. | OBD family's identifier | : | Not applicable |
| 0.2.3.9. | other family's identifier | : | Not applicable |
| 0.3. | Means of identification of type, if marked on the vehicle | : | VIN |
| 0.3.1. | Location of that marking | : | On floor frame under front passenger seat;
On the statutory plate;
On the upper left of dashboard |
| 0.4. | Category of vehicle | : | M1 |
| 0.4.1. | Classification(s) according to the dangerous goods which the vehicle is intended to transport | : | Not applicable |
| 0.5. | Company name and address of manufacturer | : | Nanjing Golden Dragon Bus Co., Ltd.
No. 369, Binhuai Street, Zhetang
Town, Lishui District, Nanjing City,
Jiangsu Province, 211200, China |
| 0.5.1. | For multi-stage approved vehicles, company name and address of the manufacturer of the base / previous stage(s) vehicle | : | Not applicable |

Manufacturer : Nanjing Golden Dragon Bus Co., Ltd.
Type : NJL6470BEV500-1

-
- 0.8. Address(es) of assembly plant(s) : Nanjing Golden Dragon Bus Co., Ltd.
No. 369, Binhuai Street, Zhetang
Town, Lishui District, Nanjing City,
Jiangsu Province, 211200, China
- 0.9. Name and address of the manufacturer's representative (if any) : BIO AUTO SP. Z O.O.
30-015 Krakow, Swietokrzyska str, 12/323, Poland

1. GENERAL CONSTRUCTION CHARACTERISTICS OF THE VEHICLE

- 1.1. Photographs and / or drawings of a representative vehicle : See Annex 3
- 1.3. Number of axles and wheels : Two axles, four wheels
- 1.3.1. Number and position of axles with twin wheels : Not applicable
- 1.3.2. Number and position of steered axles : One, front axle
- 1.3.3. Powered axles (number, position, interconnection) : One, front axle, no interconnection
- 1.4. Chassis (if any) (overall drawing) : Not applicable
- 1.6. Position and arrangement of the engine : Front, transverse
- 1.8. Hand of drive : Left hand drive
- 1.8.1. Vehicle is equipped to be driven in right / left hand traffic : Right
- 1.9. Specify if the towing vehicle is intended to tow semi-trailers or other trailers and, if the trailer is a semi-, drawbar-, centre-axle- or rigid drawbar trailer : Not applicable
- 1.10. Specify if the vehicle is specially designed for the controlled-temperature carriage of goods : Not applicable
- 1.11. Specify if the vehicle is non-automated/ automated/ fully automated : Non-automated

2. MASSES AND DIMENSIONS (IN KG AND MM)

- 2.1. Wheelbase(s) (fully loaded)
- 2.1.1. Two axle vehicles : 2800
- 2.1.2. Vehicles with three or more axles : Not applicable
- 2.3.1. Track of each steered axle : 1625
- 2.3.2. Track of all other axles : 1625
- 2.4. Range of vehicle dimensions (overall)
- 2.4.1. For chassis without bodywork : Not applicable
- 2.4.2. For chassis with bodywork
- 2.4.2.1. Length : Option 1: 4698; Option 2: 4720

Manufacturer : Nanjing Golden Dragon Bus Co., Ltd.
 Type : NJL6470BEV500-1

2.4.2.1.1.	Length of the loading area	: Not applicable
2.4.2.1.3.	Elongated cab complying with Article 9a of Directive 96/53/EC	: Not applicable
2.4.2.2.	Width	: 1908
2.4.2.2.1.	Thickness of the walls (in the case of vehicles designed for controlled-temperature transport of goods)	: Not applicable
2.4.2.3.	Height (in running order) (for suspensions adjustable for height, indicate normal running position)	: 1696
2.5.	Minimum mass on the steering axle(s) for incomplete vehicles	: Not applicable
2.6.	Mass in running order (a) minimum and maximum for each variant (b) mass of each version (a matrix must be provided)	: See Annex 4
2.6.1.	Distribution of this mass among the axles and, in the case of a semi-trailer a rigid drawbar trailer or a centre-axle trailer, the mass on the coupling (a) minimum and maximum for each variant (b) mass of each version (a matrix must be provided)	: See Annex 4
2.6.2.	Mass of the optional equipment (see definition in Implementing Regulation (EU) 2021/535, Annex XIII, Part 2, Section A, point 1.4.)	: Not applicable
2.6.4.	Additional mass for alternative propulsion	: Not applicable
2.6.5.	List of equipment to for alternative propulsion (and indication of the mass of the parts)	: Not applicable
2.7.	Minimum mass of the completed vehicle as stated by the manufacturer, in the case of an incomplete vehicle	: Not applicable
2.8.	Technically permissible maximum laden mass stated by the manufacturer	: See Annex 4
2.8.1.	Distribution of this mass among the axles and, in the case of a semi-trailer or centre-axle trailer, load on the coupling point	: See Annex 4
2.9.	Technically permissible maximum mass on each axle	: See Annex 4
2.10.	Technically permissible mass on each group of axles	: Not applicable
2.11.	Technically permissible maximum towable mass of the towing vehicle	: Not applicable
2.12.	Technically permissible maximum mass at the coupling point	: Not applicable

e13*2018/858*00339*02

Société Nationale de Certification et d'Homologation

Manufacturer : Nanjing Golden Dragon Bus Co., Ltd.
 Type : NJL6470BEV500-1

2.16. Registration/in service maximum permissible masses, vehicle categories M2, M3, N2, N3, O3 and O4 (optional) : Not applicable

2.17. Vehicle submitted to multi-stage type-approval (only in the case of incomplete or completed vehicles of category N1 within the scope of Regulation (EC) No 715/2007 of the European Parliament and of the Council : Not applicable

e13*2018/858*00339*02

3. PROPULSION ENERGY CONVERTER Société Nationale de Certification et d'Homologation

3.1. Manufacturer of the propulsion energy converter(s) : BYD Auto Industry Company Limited

3.1.1. Manufacturer's code (as marked on the propulsion energy converter or other means of identification) : TZ200XSJ

3.1.2. Number of the approval certificate (where appropriate), including fuel identification marking (Heavy Duty Vehicles only) : Not applicable

3.2. Internal combustion engine : Not applicable

3.3. Electric machine (describe information of each type of electric machine separately)

3.3.1. Type (winding, excitation) : Excitation

3.3.1.1.1. Maximum net power(manufacturer's declared value) : 150 kW @4598 r/min

3.3.1.1.2. Maximum 30min power(manufacturer's declared value) : 65 kW

3.3.1.2. Operating voltage : 200 V to 470 V

3.3.2. REESS

3.3.2.4. Position : See Annex 12

3.4. Combinations of Propulsion Energy Converters : Not applicable

3.5.9. CO₂ emissions and fuel consumption certification (for heavy-duty vehicles, as specified in Article 6 of Commission Regulation (EU) No. 2017/2400) : Not applicable

3.5.10. Declared maximum RDE values (if applicable)
 Complete RDE trip:

NOx: Not applicable
 Particles (number): Not applicable

Urban RDE trip:

NOx: Not applicable
 Particles (number): Not applicable

3.6.5. Lubricant temperature : Not applicable

4. TRANSMISSION

4.2. Type (mechanical, hydraulic, electric, etc.) : Mechanical

4.5. Gearbox

Manufacturer : Nanjing Golden Dragon Bus Co., Ltd.
 Type : NJL6470BEV500-1

4.5.1. Type (manual / automatic / CVT (continuously variable transmission)) / Fixed ratio / Automised / Other / Wheel hub : Fixed ratio

4.6. Gear ratios

Gear	Internal gearbox ratios (ratios of engine to gearbox output shaft revolutions)	Final drive ratio(s) (ratio of gearbox output shaft to driven wheel revolutions)	Total gear ratios
D	10.75	1	10.75
S	10.75		10.75
Reverse	10.75		10.75

4.7. Maximum vehicle design speed (in km/h) : 150 km/h

4.9. Tachograph : Not applicable

4.9.1. Approval mark : Not applicable

4.11. Gear Shift Indicator (GSI) : Not applicable

5. AXLES

5.1. Description of each axle : Front axle acts as powered & steered axle

5.2. Make : See Annex 7 and 8

5.3. Type : See Annex 7 and 8

5.4. Position of retractable axle(s) : Not applicable

5.5. Position of loadable axle(s) : Not applicable

6. SUSPENSION

6.2. Type and design of the suspension of each axle or group of axles or wheel : Front - MacPherson strut independent suspension
 Rear - Multi-link type independent suspension

6.2.1. Level adjustment : ~~Yes~~ / no / ~~optional~~

6.2.3. Air-suspension for driving axle(s) : ~~Yes~~ / no

6.2.3.1. Suspension of driving axle(s) equivalent to air-suspension : ~~Yes~~ / no

6.2.4. Air-suspension for non-driving axle(s) : ~~Yes~~ / no

6.2.4.1. Suspension of non-driving axle(s) equivalent to air-suspension : ~~Yes~~ / no

6.6.1. Tire/wheel combination(s) : **e13*2018/858*00339*02**
Société Nationale de Certification et d'Homologation

6.6.1.1. Axles

6.6.1.1.1. Axle 1 : See table below

Manufacturer : Nanjing Golden Dragon Bus Co., Ltd.
 Type : NJL6470BEV500-1

Axle	Size designation	Load-capacity index	Speed category symbol	Rim size	Off-set (mm)
1&2	235/50 R19	99	V	19x7.5J	45

6.6.1.1.2. Axle 2 : Same with Axle 1

6.6.1.2. Spare wheel, if any : No

6.6.2. Upper and lower limit of rolling radii : 349 mm

6.7. Tyre pressure monitoring system (TPMS)

6.7.1. Presence : ~~Yes~~ / no

7. STEERING

e13*2018/858*00339*02

Société Nationale de Certification et d'Homologation

7.2. Transmission and control

7.2.1. Type of steering transmission (specify for front and rear, if applicable) : Front: Electronic power assisted rack and pinion
Rear: not applicable

7.2.2. Linkage to wheels (including other than mechanical means; specify for front and rear, if applicable) : See Annex 9

7.2.3. Method of assistance, if any : Electric power assisted steering

7.4. Emergency lane-keeping system (ELKS)

7.4.1. Presence : ~~Yes~~ / no

7.5. Lane Departure Warning System (LDWS)

7.5.1. Presence : ~~Yes~~ / no

7.6. Corrective Directional Control Function (CDCF)

7.6.1. Presence : ~~Yes~~ / no

8. BRAKES

8.5. Anti-lock braking system : Yes / ~~no~~ / optional

Manufacturer : Nanjing Golden Dragon Bus Co., Ltd.
 Type : NJL6470BEV500-1

-
- 8.9. Brief description of the braking system according to paragraph 12 of Annex 2 to UN Regulation No 13H : Service braking system:
 - Auxiliary force
 - Foot pedal type
 - Mechanical hydraulic transfer
 - Two circuits
 - X distribution
 - Disc brake on front axle
 - Disc brake on rear axle
 - ABS : standard
 - ESC : standard
 - BAS : standard
- Secondary braking system:
 One circuit of the service braking system
- Parking braking system:
 Electrical parking brake system
 - Operating on axle 2
 - Electronically controlled and mechanically applied
- e13*2018/858*00339*02
 Société Nationale de Certification et d'Homologation
- 8.11. Particulars of the type(s) of endurance braking system(s) : Not applicable
- 8.12. Advanced emergency braking system (AEBS)
- 8.12.1. Presence : ~~Yes~~ / no
- 9. BODYWORK**
- 9.1. Type of bodywork using the codes defined in Part C of Annex I to Regulation (EU) 2018/858 or in case of a special purpose vehicle the codes defined in point 5 to Part A of that Annex : AF
- 9.3. Occupant doors, latches and hinges
- 9.3.1. Door configuration and number of doors : 4 hinged side doors;
 1 back door, open in vertical
- 9.9. Devices for indirect vision
- 9.9.1. Rear-view mirrors, stating, for each rear-view mirror
- 9.9.1.1. Make : See Annex 10
- 9.9.1.2. Type-approval mark : See Annex 10
- 9.9.1.3. Variant : Not applicable
- 9.9.1.6. Optional equipment which may affect the rearward field of vision : Not applicable
- 9.9.2. Devices for indirect vision other than mirrors : Not applicable
- 9.10. Interior arrangement
- 9.10.3. Seats

Manufacturer : Nanjing Golden Dragon Bus Co., Ltd.
 Type : NJL6470BEV500-1

- 9.10.3.1. Number of seating positions : 5
- 9.10.3.1.1. Location and arrangement : 1st row: 2 individual seats
2nd row: 4/6 split seats with 3 seating position
- 9.10.3.2. Seat(s) designated for use only when the vehicle is stationary : Not applicable
- 9.10.4.1. Type(s) of head restraints : Detachable
- 9.10.4.2. Type-approval number(s), if available : Not applicable
- 9.10.8. Gas used as refrigerant in the air-conditioning system : R-1234yf
- 9.10.8.1. The air-conditioning system is designed to contain fluorinated greenhouse gases with a global warming potential higher than 150 : yes/no
- 9.12.2. Nature and position of supplementary restraint systems : See table below

		Front airbag	Side airbag	Belt pre-loading device	Side curtain airbag
1st row of seats	L	Yes	Yes	Yes	Yes
	R	Yes	Yes	Yes	Yes
2nd row of seats	L	No	No	Yes	Yes
	C	No	No	No	No
	R	No	No	No	Yes

(L = left-hand side, C = Centre seat, R = right-hand side)

- 9.17. Statutory plates
- 9.17.1. Photographs and/or drawings of the locations of the statutory plates and inscriptions and of the vehicle identification number : See Annex 6
- 9.17.2. Photographs and/or drawings of the statutory plate and inscriptions (completed example with dimensions) : See Annex 2
- 9.17.3. Photographs and/or drawings of the vehicle identification number (completed example with dimensions) : See Annex 6
- 9.17.4.1. The meaning of characters in the vehicle descriptor section (VDS) of the vehicle identification number (VIN) and, if applicable, the vehicle indicator section (VIS) thereof, to comply with the requirements of Section 5.3. of ISO Standard 3779:2009 shall be explained : See Annex 1
- 9.17.4.2. If characters in the vehicle descriptor second section are used to comply with the requirements of section 5.4 of ISO Standard 3779:2009 these characters shall be indicated : See Annex 1
- 9.22. Front under-run protection
- 9.22.0. Presence : Not applicable

e13*2018/858*00339*02

Société Nationale de Certification et d'Homologation

Manufacturer : Nanjing Golden Dragon Bus Co., Ltd.
 Type : NJL6470BEV500-1

9.23.	Pedestrian protection	: Not applicable
9.24.	Frontal Protection Systems	: Not applicable
11.	CONNECTIONS BETWEEN TOWING VEHICLES AND TRAILERS AND SEMI-TRAILERS	
11.1.	Class and type of the coupling device(s) fitted or to be fitted	: Not applicable
11.3.	Instructions for attachment of the coupling type to the vehicle and photographs or drawings of the fixing points at the vehicle as stated by the manufacturer; additional information, if the use of the coupling type is restricted to certain variants or versions of the vehicle type	: Not applicable
11.4.	Information of the fitting of special towing brackets or mounting plates	: Not applicable
11.5.	Number(s) of the type-approval certificate(s)	: Not applicable
12.	MISCELLANEOUS	e13*2018/858*00339*02 Société Nationale de Certification et d'Homologation
12.2.4.	Alcohol interlock installation facilitation (AIF)	
12.2.4.1.	Manufacturer's declaration of compliance, in accordance with Annex I to Commission Delegated Regulation (EU) 2021/1243	: Not applicable
12.6.5.	Intelligent speed assistance system (ISA)	
12.6.5.1.	Presence	: Yes / no
12.7.1.	Vehicle equipped with 24 GHz short-range radar equipment	: Yes / no
12.8.	eCall System	
12.8.1.	Presence	: Yes / no
12.9.	Acoustic Vehicle Alerting System (AVAS)	
12.9.1.	The number of the approval certificate issued on the basis of requirements laid down in UN Regulation No 138 of the Economic Commission for Europe of the United Nations (UNECE)	: Not applicable
12.9.2.	Complete reference to the test results of AVAS sound emission levels, measured in accordance with Regulation (EU) No 540/2014 of the European Parliament and of the Council	: <u>See approval e13*540/2014*2019/839C*0045*01</u>
12.11.	Driver drowsiness and attention warning (DDAW) system	
12.11.1.	Presence	: Yes / no
12.12.	Advanced driver distraction warning (ADDW) system	
12.12.1.	Presence	: Yes / no

Manufacturer : Nanjing Golden Dragon Bus Co., Ltd.
Type : NJL6470BEV500-1

- 12.13. Blind spot information system (BSIS)
- 12.13.1. Presence : ~~Yes~~ / no
- 12.16. Event data recorder (EDR)
- 12.16.1. Presence : ~~Yes~~ / no
- 12.17. Driver availability monitoring (DAM) system
- 12.17.1. Presence : ~~Yes~~ / no

e13*2018/858*00339*02
Société Nationale de Certification et d'Homologation

Manufacturer : Nanjing Golden Dragon Bus Co., Ltd.
Type : NJL6470BEV500-1

13. SPECIAL PROVISIONS FOR BUSES AND COACHES

13.1. Class of vehicle : Not applicable

13.1.2. Chassis types where the type-approved bodywork can be installed (manufacturer(s), and type of incomplete vehicle(s)) : Not applicable

13.3. Number of passengers (seated and standing)

13.3.1. Total (N) : Not applicable

13.3.2. Upper deck (Na) : Not applicable

13.3.3. Lower deck (Nb) : Not applicable

13.4. Number of passengers (seated)

13.4.1. Total (A) : Not applicable

13.4.2. Upper deck (Aa) : Not applicable

13.4.3. Lower deck (Ab) : Not applicable

13.4.4. Number of wheelchair positions for ~~Category M2 and~~ M3 vehicles : Not applicable

16. ACCESS TO VEHICLE REPAIR AND MAINTENANCE INFORMATION

16.1. Address of principal website for access to vehicle repair and maintenance information : <https://en.skywellev.com/>

17. AUTOMATED DRIVING SYSTEM (ADS) : ~~Yes~~ / no

Manufacturer : Nanjing Golden Dragon Bus Co., Ltd.
 Type : NJL6470BEV500-1

PART II Matrix showing the combinations of the entries listed in Part I within the versions and variants of the vehicle type

e13*2018/858*00339*02

Société Nationale de Certification et d'Homologation

Type	NJL6470BEV500-1
Variant	BET1
Version	AAAA5A, <u>BAAB5A</u>

Variant description

No.	Essential respect	Code	Configuration
1	Number of lateral doors	B	A - 2; B - 4
2	Power plant	E	E- electric motor; I- internal combustion engine
3	Axle number/steered axle	T	T- two axle/front axle;
4	Powered axle	1	1 - Front; 2 - Front and Rear

Version description

No.	Essential respect	Code	Configuration
1	GVW	<u>A/B</u>	Sequence number: A, B, C.... A - 2255 kg; <u>B - 2305 kg</u>
2	Wheelbase	A	Sequence number: A, B, C.... A - 2800 mm
3	Maximum net power	A	Sequence number: A, B, C.... A - 150 kW
4	Battery capacity	<u>A/B</u>	Sequence number: A, B, C.... A - Capacity 192 Ah; <u>B - 244 Ah</u>
5	Seating positions	5	2 - two seats ; 4 - four seats; 5 - 5 seats
6	Reducer gear ratio	A	A - 10.75

Manufacturer : Nanjing Golden Dragon Bus Co., Ltd.
 Type : NJL6470BEV500-1

Part III

No.	Subject	Approval No.	Member state issue the type approval	Extension date	Variant(s)/ version(s)
1A	Sound Levels	<u>e13*540/2014*2019/839C*0045*01</u>	Luxemburg	<u>2022-10-12</u>	<u>All</u>
2	Emission light duty/access to information ¹⁾	<u>e13*715/2007*2018/1832AX*07768*02</u>	Luxemburg	<u>2022-10-12</u>	<u>BET1/AAAA5A</u>
		<u>e13*715/2007*2018/1832AX*07938*00</u>	Luxemburg	--	<u>BET1/BAAB5A</u>
3B	Rear Underrun Protection	<u>E13*58R03/03*9377*01</u>	Luxemburg	<u>2022-10-18</u>	<u>All</u>
4A	Rear Registration Plate Space	<u>e13*1003/2010*2015/166*00142*01</u>	Luxemburg	<u>2022-10-12</u>	<u>All</u>
5A	Steering Effort	<u>E13*79R03/06*2720*02</u>	Luxemburg	<u>2022-10-18</u>	<u>All</u>
6B	Door latches	<u>E13*11R04/02*6140*01</u>	Luxemburg	<u>2022-10-07</u>	<u>All</u>
7A	Audible Warning	<u>E13*28R00/06*6259*01</u>	Luxemburg	<u>2022-10-18</u>	<u>All</u>
8A	Indirect Vision	<u>E13*46R04/09*10059*01</u>	Luxemburg	<u>2022-10-12</u>	<u>All</u>
9B	Braking	<u>E13*13HR01/01*6395*01</u>	Luxemburg	<u>2022-10-19</u>	<u>All</u>
10A	EMC	<u>E13*10R06/01*15895*02</u>	Luxemburg	<u>2022-10-19</u>	<u>All</u>
12A	Interior fittings	<u>E13*21R01/04*8590*02</u>	Luxemburg	<u>2022-10-08</u>	<u>All</u>
13B	Anti-theft	<u>E13*116R00/07*1031*01</u>	Luxemburg	<u>2022-10-12</u>	<u>All</u>
14A	Steering Protection	<u>E13*12R04/05*9743*02</u>	Luxemburg	<u>2022-10-19</u>	<u>All</u>
15A	Seat Strength	<u>E13*17RA09/01*6228*01</u>	Luxemburg	<u>2022-10-08</u>	<u>All</u>
16A	External projections	<u>E13*26R03/04*8625*02</u>	Luxemburg	<u>2022-10-19</u>	<u>All</u>
6A/ 17A	Vehicle Access and Manoeuvrability	<u>e13*130/2012*130/2012*00147*01</u>	Luxemburg	<u>2022-10-12</u>	<u>All</u>
17B	Speedometer	<u>E13*39R01/01*10001*01</u>	Luxemburg	<u>2022-10-12</u>	<u>All</u>
18A	Statutory Plate	<u>e13*19/2011*249/2012*01601*01</u>	Luxemburg	<u>2022-10-08</u>	<u>All</u>
19A	Safety-belt anchorages	<u>E13*14R09/02*9799*01</u>	Luxemburg	<u>2022-10-18</u>	<u>All</u>
20A	Lighting Installations	<u>E13*48R06/13*10037*02</u>	Luxemburg	<u>2022-10-19</u>	<u>All</u>
27A	Towing Device	<u>e13*1005/2010*1005/2010*0146*01</u>	Luxemburg	<u>2022-10-12</u>	<u>All</u>
31A	Safety-belts Installation	<u>E13*16R08/03*10298*01</u>	Luxemburg	<u>2022-10-17</u>	<u>All</u>
32A	Forward field of vision	<u>E13*125R01/02*6039*01</u>	Luxemburg	<u>2022-10-12</u>	<u>All</u>
33A	Identification of Controls	<u>E13*121R01/04*6154*01</u>	Luxemburg	<u>2022-10-08</u>	<u>All</u>

e13*2018/858*00339*02

Société Nationale de Certification et d'Homologation

Manufacturer : Nanjing Golden Dragon Bus Co., Ltd.
 Type : NJL6470BEV500-1

No.	Subject	Approval No.	Member state issue the type approval	Extension date	Variant(s)/ version(s)
34A	Defrosting and demisting systems	<u>e13*672/2010*672/2010*00131*01</u>	Luxembourg	<u>2022-10-08</u>	<u>All</u>
35A	Windscreen wiper and washer systems	<u>e13*1008/2010*1008/2010*00206*01</u>	Luxembourg	<u>2022-10-12</u>	<u>All</u>
36A	Heating systems	<u>E13*122R00/06*0260*01</u>	Luxembourg	<u>2022-10-12</u>	<u>All</u>
37A	Wheel guards	<u>e13*1009/2010*1009/2010*00099*01</u>	Luxembourg	<u>2022-10-18</u>	<u>All</u>
38A	Head restraints	Refer to 15A			
44A	Masses and dimensions	<u>e13*1230/2012*2019/1892*00206*02</u>	Luxembourg	<u>2022-10-18</u>	<u>All</u>
45A	Safety Glazing	<u>E13*43R01/09*9996*02</u>	Luxembourg	<u>2022-10-08</u>	<u>All</u>
46A	Tyres Installation	<u>E13*142R01/00*0029*01</u>	Luxembourg	<u>2022-10-12</u>	<u>All</u>
53A	Frontal collision	<u>E13*94R03/02*6418*02</u>	Luxembourg	<u>2022-10-19</u>	<u>All</u>
54A	Lateral collision	<u>E13*95R03/07*9780*01</u>	Luxembourg	<u>2022-10-19</u>	<u>All</u>
58	Pedestrian protection	<u>E13*127R02/00*0169*02</u>	Luxembourg	<u>2022-10-18</u>	<u>All</u>
59	Recyclability	<u>e13*2005/64*2009/1*00144*01</u>	Luxembourg	<u>2022-10-18</u>	<u>All</u>
61	Air-conditioning systems	<u>e13*2006/40*706/2007*00146*01</u>	Luxembourg	<u>2022-10-08</u>	<u>All</u>
63	General Safety	See individual legal acts of Regulation (EU) No. 2019/2144			
68	Vehicle alarm systems (VAS)	<u>E13*116R00/08*1031*01</u>	Luxembourg	<u>2022-10-12</u>	<u>All</u>
69	Electric Safety	<u>E13*100R02/04*0197*02</u>	Luxembourg	<u>2022-10-19</u>	<u>All</u>
72	eCall system	<u>e13*2015/758*2017/79*00082*01</u>	Luxembourg	<u>2022-10-12</u>	<u>All</u>
	BAS	<u>E13*139R00/02*0093*01</u>	Luxembourg	<u>2022-10-12</u>	<u>All</u>
	ESC	<u>E13*140R00/04*0092*01</u>	Luxembourg	<u>2022-10-12</u>	<u>All</u>
	TPMS	<u>E13*141R01/00*0038*02</u>	Luxembourg	<u>2022-10-12</u>	<u>All</u>
	ISOFIX	<u>E13*145R00/01*0047*01</u>	Luxembourg	<u>2022-10-19</u>	<u>All</u>

1) This vehicle type is pure electric vehicle, only fulfilled engine power and electric energy consumption and electric range according to paragraph 2.4, Annex I, Regulation (EU) No. 2017/1151 as amended by (EU) No. 2018/1832.

e13*2018/858*00339*02

Société Nationale de Certification et d'Homologation

陈乾坤

Qiankun Chen
 Manager of homologation department
 October 19, 2022

Manufacturer : Nanjing Golden Dragon Bus Co., Ltd.
 Type : NJL6470BEV500-1

Annex 1 Vehicle Identification Number system

e13*2018/858*00339*02
 Société Nationale de Certification et d'Homologation

WMI			VDS						VIS							
1	2	3	4	5	6	7	8	9	10	11	12	13	14	15	16	17
L	M	E	L	B	L	1	P	1	L	R	C	0	0	5	8	7

Sample:

1 ~ 3 World Manufacturer Identification: LME - Nanjing Golden Dragon Bus Co., Ltd.

4. Vehicle type: L – Multipurpose passenger car

5. Body/cab type : B – Unitary construction body

6. Type of vehicle power battery: L - Ternary lithium battery

7-8. Drive motor peak power: 1 - Pure electric, P - 150kW

9. Check digit

10. Model Year:
 K - 2019, L - 2020, M - 2021, N - 2022, P - 2023, R - 2024, S - 2025
 Letters go around every 30 years. I, O, and Q cannot be used

11. Assembly plant:
 R - Nanjing Golden Dragon Bus Co., Ltd.

12. Manufacturing line
 C – the first production line for passenger car

13 ~ 17: Production Serial Number: ***** It is a serial number.

Manufacturer : Nanjing Golden Dragon Bus Co., Ltd.
Type : NJL6470BEV500-1

Annex 2 Manufacturer's plate

e13*2018/858*00339*02

Société Nationale de Certification et d'Homologation

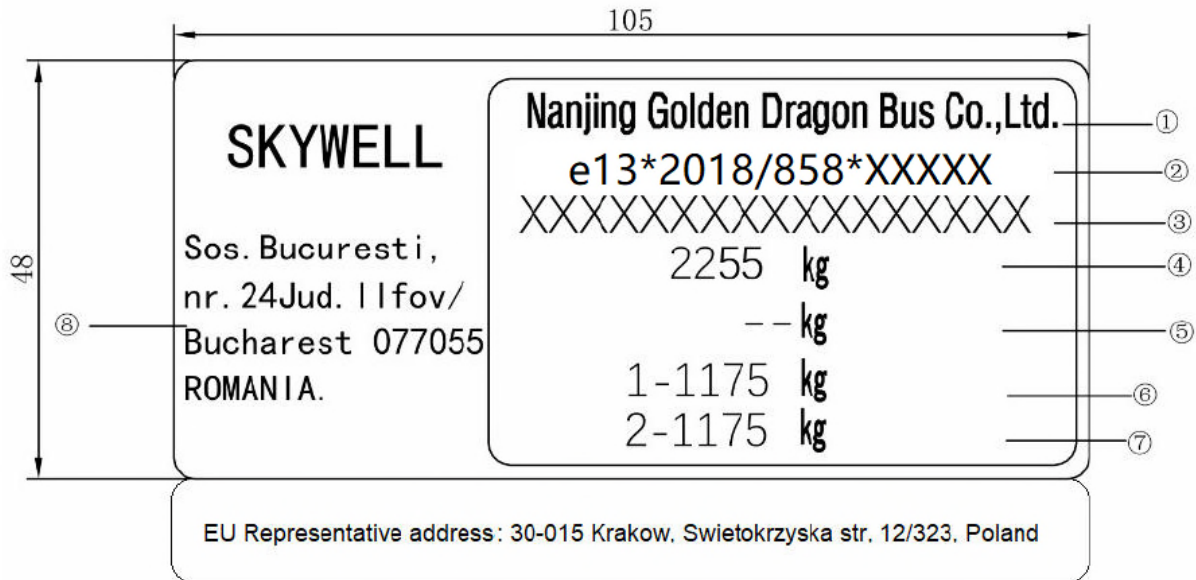

Explanartion:

Font height of all characters in box 4mm.

No spaces between characters.

Shaded area to colored black.

Numerical:

①Name of the manufactuer.

②The whole vehicle type-approval number.

③Vehice indentification number.

④Maximum permitted laden mass of the vehicle.

⑤Maximum permitted laden mass for the combination.

⑥maximum permitted road mass for front axle.

⑦maximum permitted road mass for rear axle.

⑧The manufacturer's contact address in the EU.

Annex 3 Views of the vehicle

e13*2018/858*00339*02
Société Nationale de Certification et d'Homologation

Option 1

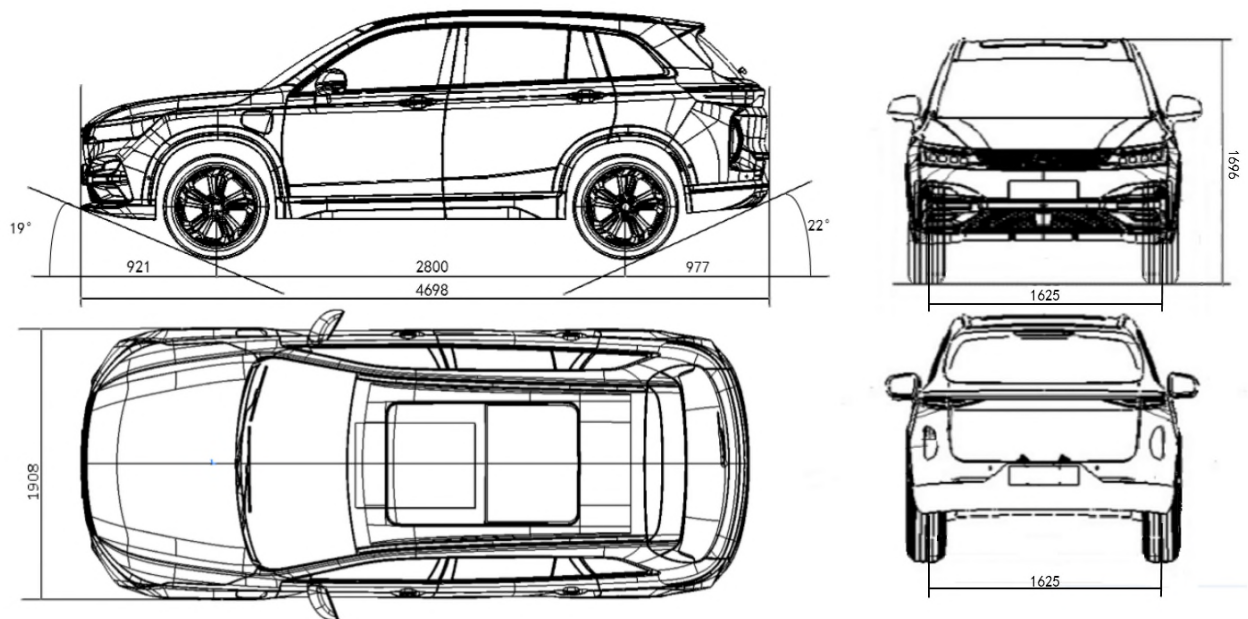

Option 2:

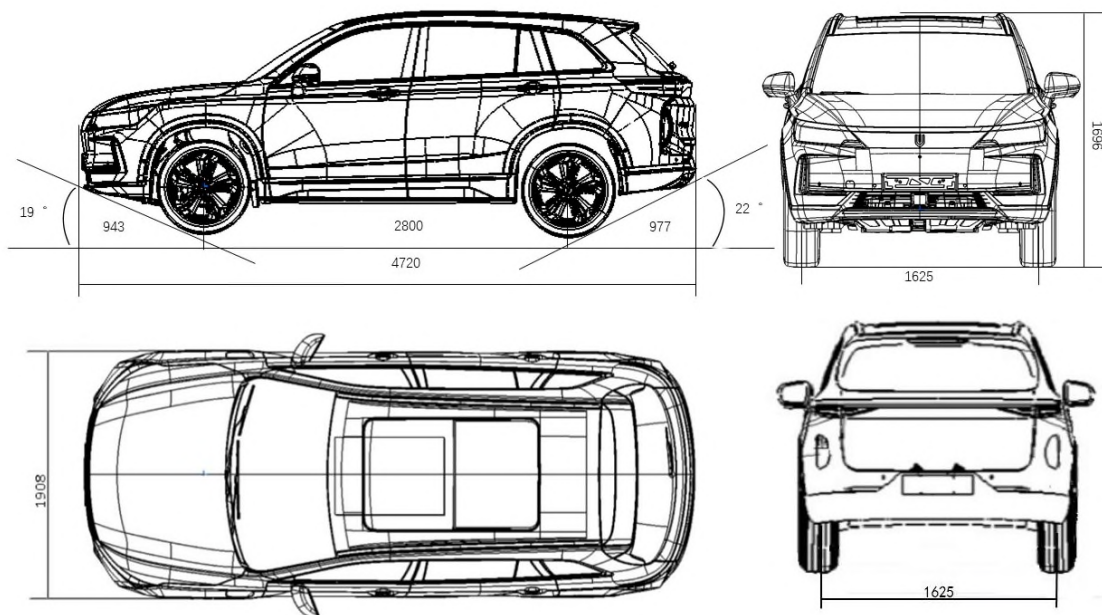

unit: mm

Remark: the opening roof glazing is optional

Manufacturer : Nanjing Golden Dragon Bus Co., Ltd.
 Type : NJL6470BEV500-1

Annex 4 Mass of the vehicle

e13*2018/858*00339*02
 Société Nationale de Certification et d'Homologation

Variant-version	2.6.	2.6.1.		2.8.	2.8.1.		2.9.	
	Weight of the vehicle with body work in running order (with driver) (kg)	Distribution of this weight among the axle		Technically permissible maximum laden weight (kg)	Distribution of this weight among the axle		Technically permissible maximum weight on each axle	
		Front (kg)	Rear (kg)		Front (kg)	Rear (kg)	Front (kg)	Rear (kg)
BET1 - AAAA5A	1955	1048	907	2255	1122	1133	1175	1175
BET1 - BAAB5A	2005	1085	920	2305	1152	1153	1175	1175

Annex 5 Drawing of seat arrangement and R points

e13*2018/858*00339*02
Société Nationale de Certification et d'Homologation

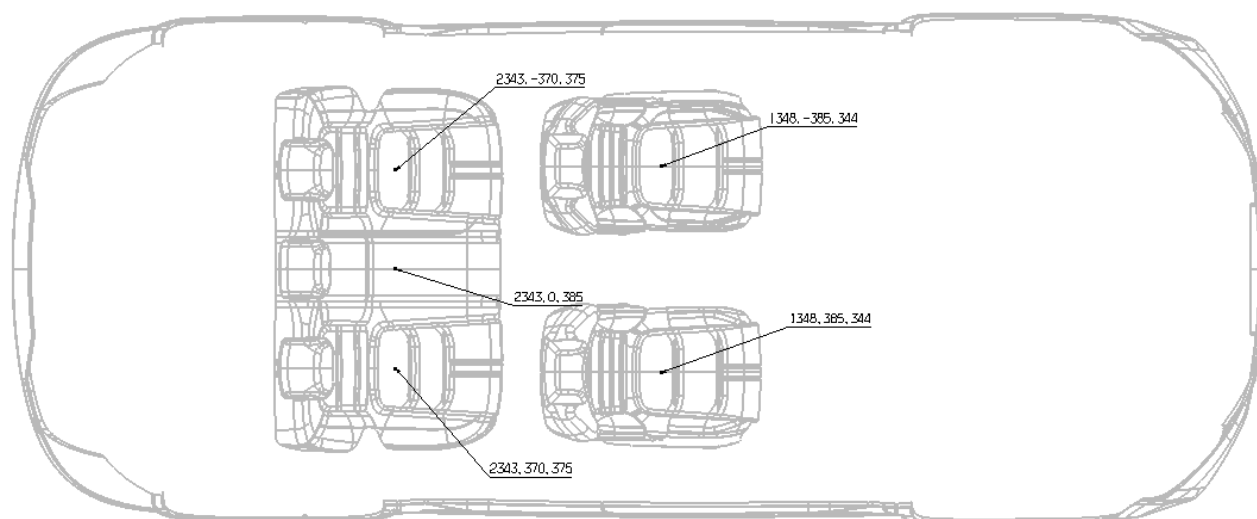

unit: mm

Annex 6 Location of statutory plate and VIN

e13*2018/858*00339*02

Société Nationale de Certification et d'Homologation

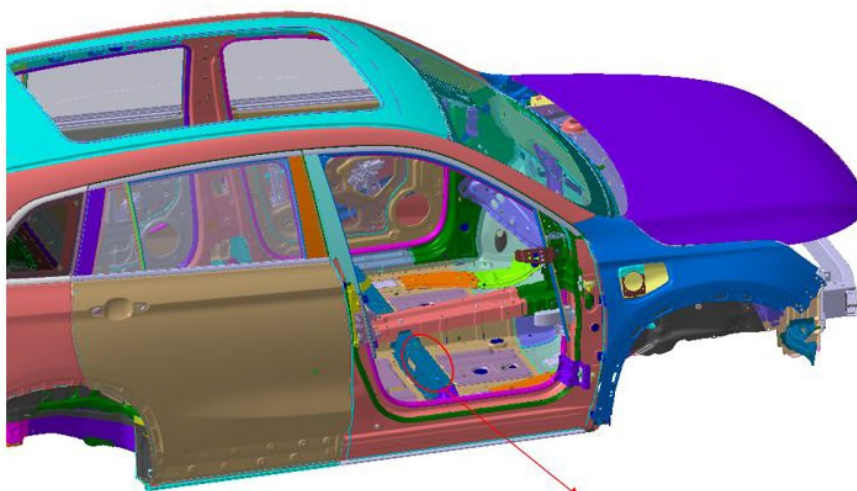

Location of VIN

Marking method :Hammering

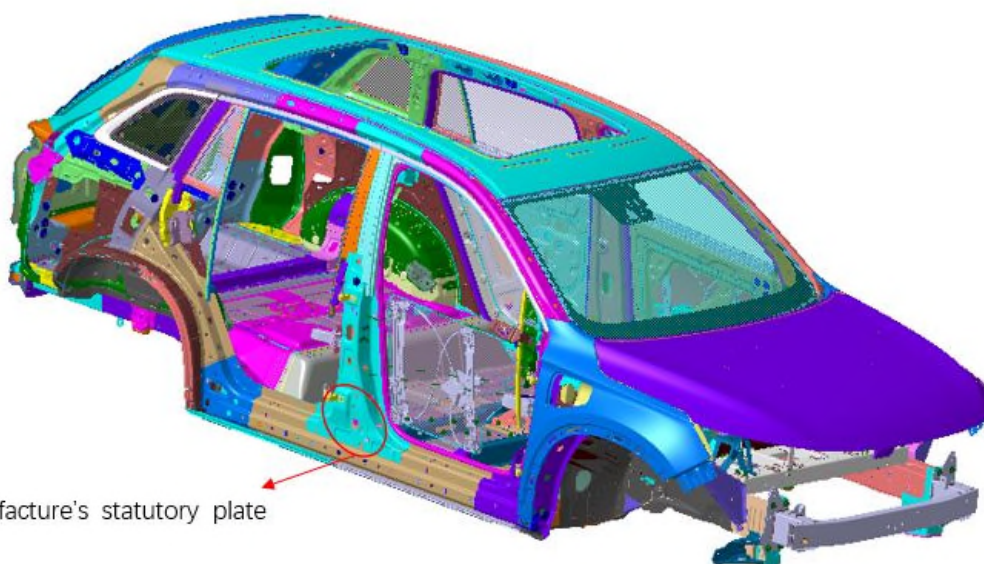

Manufacture's statutory plate

unit: mm

Annex 7 Drawing of front suspension and front axle

e13*2018/858*00339*02

Société Nationale de Certification et d'Homologation

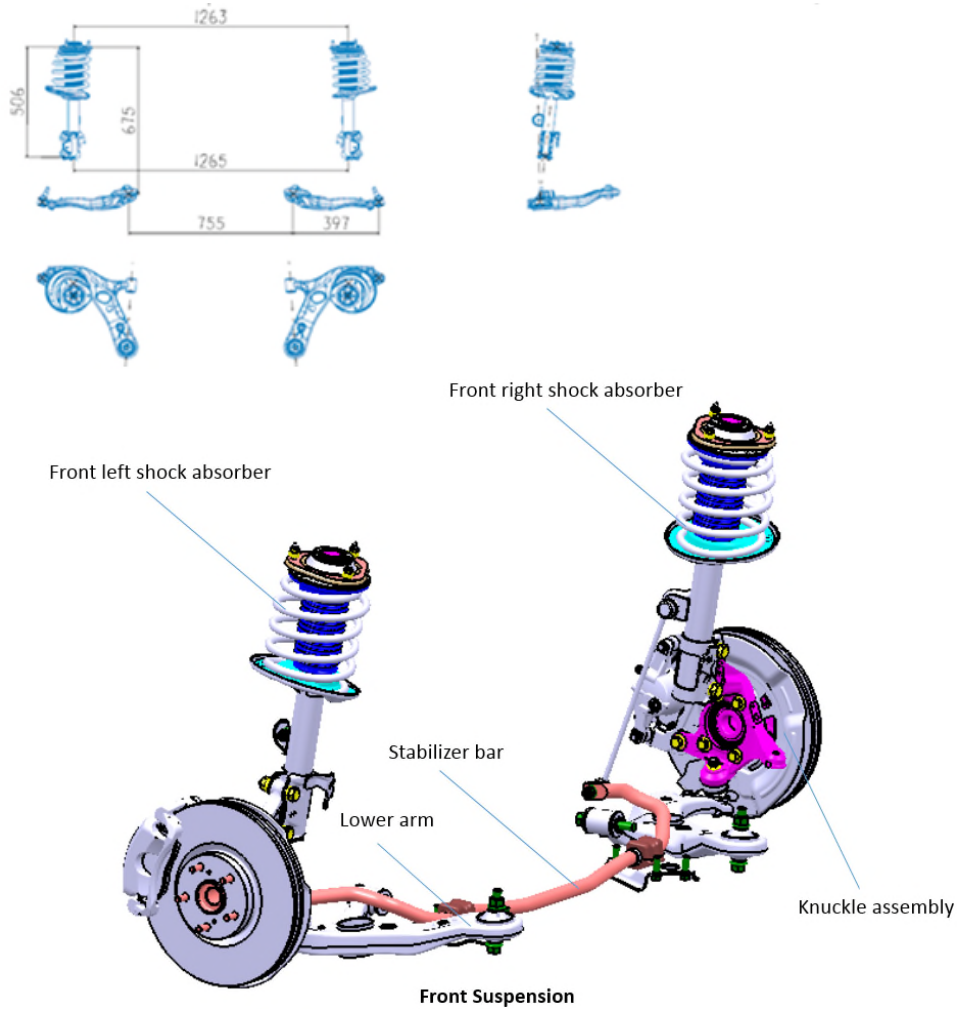

Maker: Nanjing Golden Dragon Bus Co., Ltd.
Type: C2020005BAA

unit: mm

Front axle

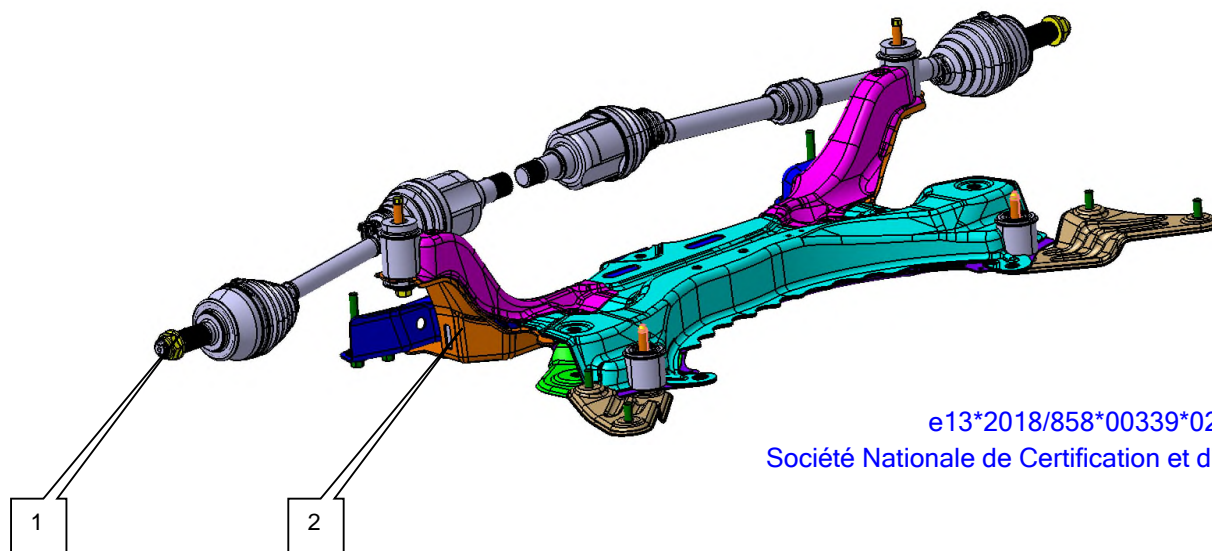

e13*2018/858*00339*02
Société Nationale de Certification et d'Homologation

1. DRIVE SHAFT ASSY
Type: C2060001BAA
Maker: Ning Bo V-SHINE Auto parts Co., Ltd.
2. SUBFRAME ASSY FRT
Type: C2050002BAA
Maker: Ningbo Huizhong Automotive Chassis Manufacturing Co., Ltd.

Annex 8 Drawing of rear suspension and rear axle

e13*2018/858*00339*02

Société Nationale de Certification et d'Homologation

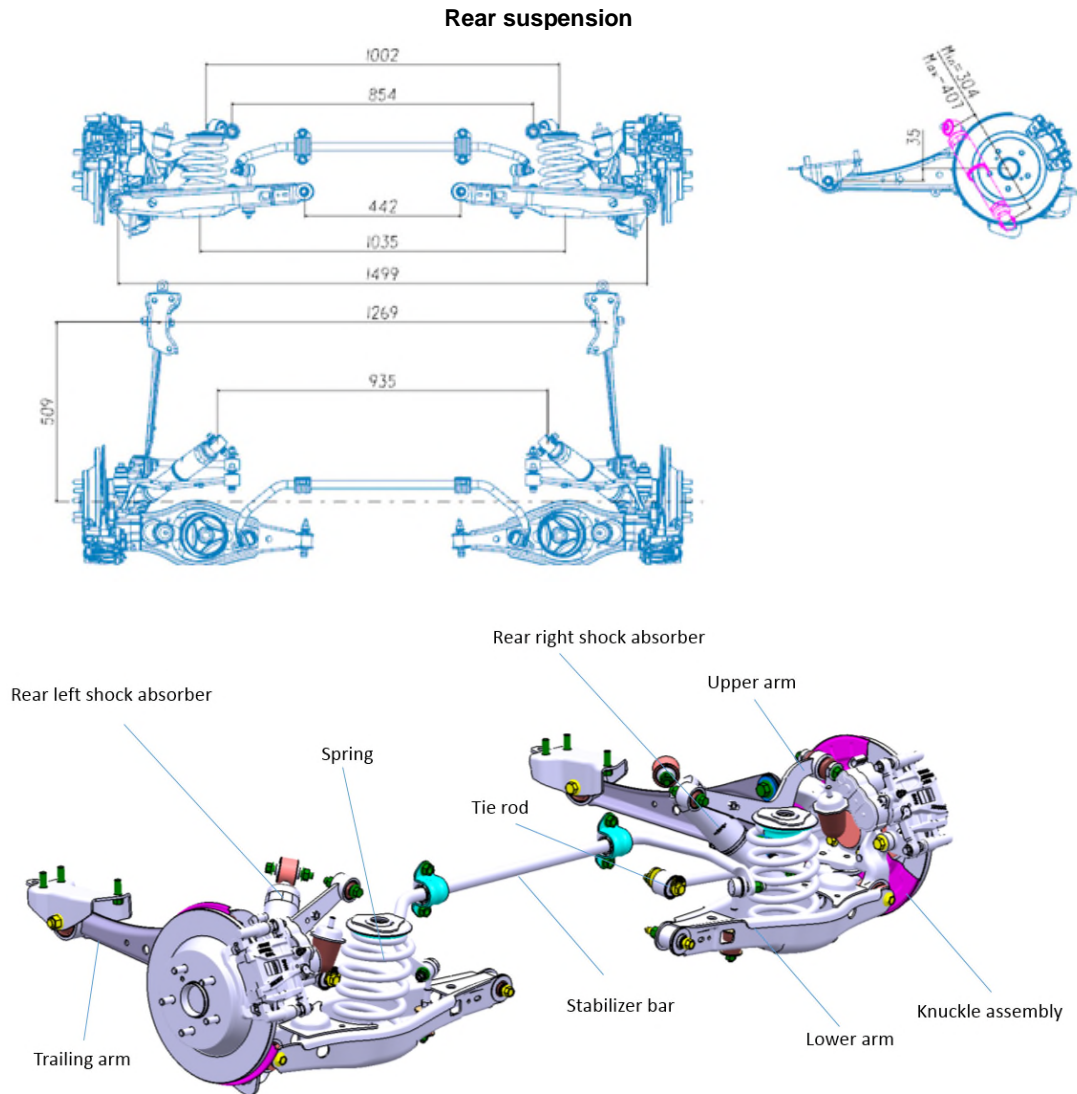

Maker: Nanjing Golden Dragon Bus Co., Ltd.
Type: C2020006BAA

unit: mm

Manufacturer : Nanjing Golden Dragon Bus Co., Ltd.
Type : NJL6470BEV500-1

Rear axle

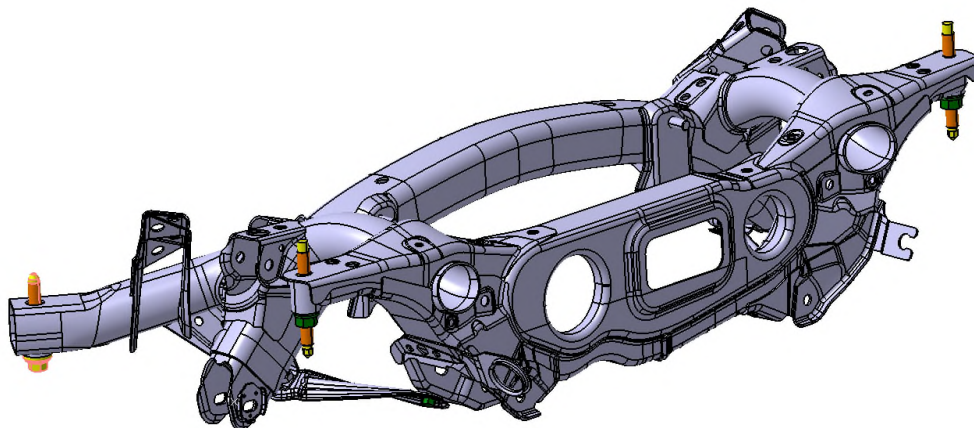

e13*2018/858*00339*02

Société Nationale de Certification et d'Homologation

SUBFRAME ASSY RR

Type: C2050003BAA

Maker: Ningbo Huizhong Automotive Chassis Manufacturing Co., Ltd.

Annex 9 Drawing of sketch of steering system

e13*2018/858*00339*02

Société Nationale de Certification et d'Homologation

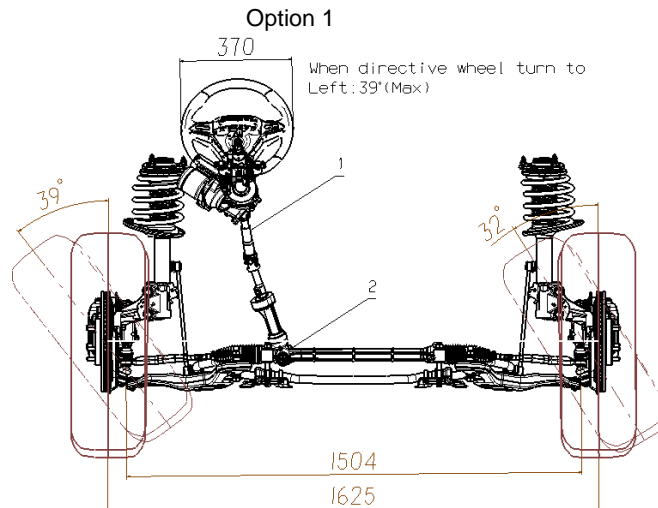

MIN TURNING CIRCLE: 11.6M
MAX TURNING ANGLE OF STEERING WHEEL: INNER: 39°, OUTER: 32°

1. COLUMN ASSY COLPS STRG ASSY
2. MONOLITHIC MACHINERY STEERING GEAR ASSY

Make: WUHU STERLING STEERING SYSTEM CO., LTD
Type: C2010001BAA

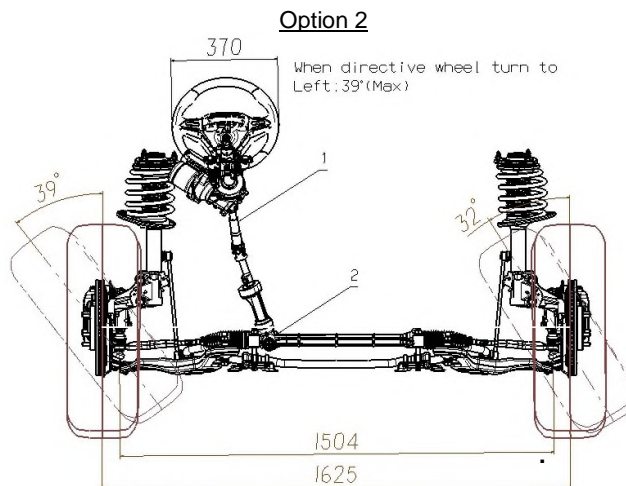

MIN TURNING CIRCLE: 11.6M
MAX TURNING ANGLE OF STEERING WHEEL: INNER: 39°, OUTER: 32°

1. COLUMN ASSY COLPS STRG ASSY
2. MONOLITHIC MACHINERY STEERING GEAR ASSY

Make: WUHU STERLING STEERING SYSTEM CO., LTD
Type: B1201002C0

The steering wheel rotates to drive the electric steering column (assisted by the normal steering motor), the steering column moves the steering rack, the steering rack moves to drive the steering tie rod, and the steering tie rod moves the steering knuckle around the main pin, thereby driving the wheels to rotate.

unit: mm

Option 1

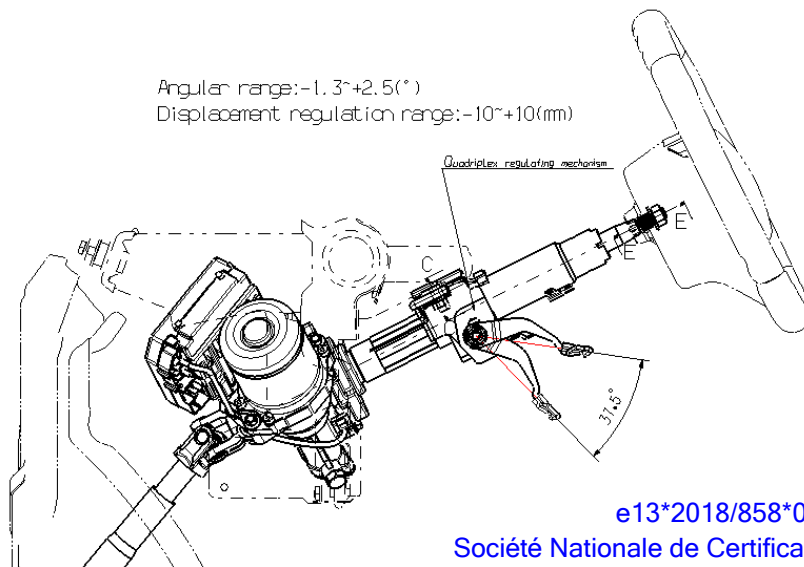

Option 2

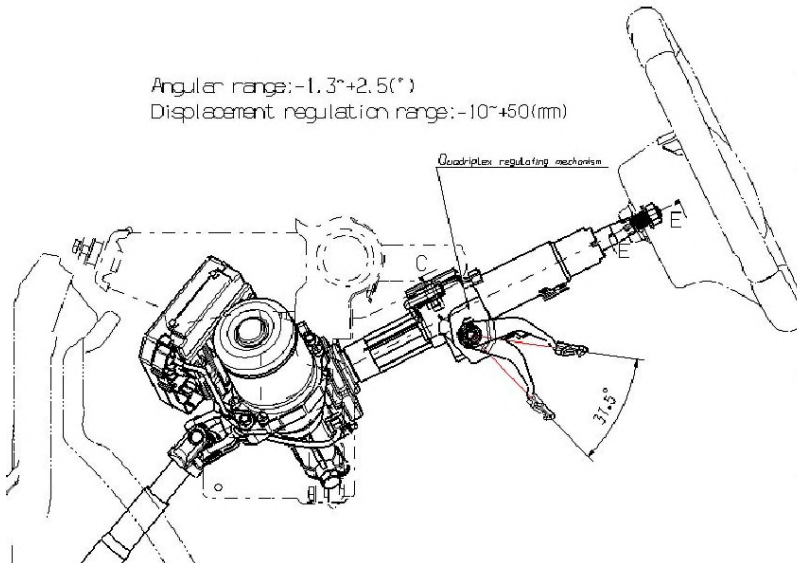

Remark: The shaft tube for the adjustment on the steering shaft is lengthened relative to option 1

Manufacturer : Nanjing Golden Dragon Bus Co., Ltd.
 Type : NJL6470BEV500-1

Annex 10 List of rear view mirror

e13*2018/858*00339*02

Société Nationale de Certification et d'Homologation

External rear-view mirror

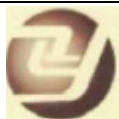
Type	B1604012DW
Trade mark	
Class	III
Approval mark	E13*46R04/08*10049*00
Number	2
Place of mounting	On both sides of the front doors

Internal rear-view mirror

Type	GNTX-533
Trade mark	GNTX
Class	I
Approval mark	E11-46R-046004
Number	1
Place of mounting	Mounted on the middle of the windshield upper

Manufacturer : Nanjing Golden Dragon Bus Co., Ltd.
 Type : NJL6470BEV500-1

Annex 11 Overview of the high voltage electric components arrangement and location on the vehicle

No.	Type	Part	Make	Specification
1	TZ200XSJ	Motor	BYD Auto Industry Company Limited	320Nm Voltage Range: 200-470V Rated Voltage: 350VDC Rated Power: 65kW Maximum Power: 150kW
	TZ35X51S	Motor controller		
	BYDNT33	Reducer		
2	E34FT350A-9585HS	Compressor	Nanjing Aotecar Co., Ltd.	Voltage Range: 180-470VDC Rated Voltage: 350VDC Rated Power: 4.4kW Maximum Power: 6kW
3	Option 1: VAILD6047 Option 2: LWD2KCB11KB-D14C380-W-NJL2-1	DC-DC	Option 1: Shenzhen VMAX Co., Ltd. Option 2: landworld Co., Ltd.	DC/DC: 2.5Kw(DC)
4		On-board charge		Option 1: 220V/AC 6.6KW Option 2: 380V/AC 11kW
5		High voltage box		Voltage Range: 240-450VDC Rated Voltage: 350VDC
6	C1040210BAA	PTC	Jiangsu Chaoli Co., Ltd.	Voltage Range: 250-450VDC Rated Voltage: 350VDC Rated Power: 5kW Maximum Power: 7kW
7-1	Option 1: PBM375192-A01	Battery	Farasis Energy(Gan Zhou) Co., Ltd.	Nominal voltage: 374.92VDC Working voltage: 309~437.75 V Capacity: 192Ah
7-2	<u>Option 2: SP-BE11-1P96S-1</u>	<u>Battery</u>	<u>Jiangsu Skyworth Power Technology Co., Ltd.</u>	<u>Nominal voltage:</u> <u>352.32VDC</u> <u>Working voltage:</u> <u>268.8~417.6 V</u> <u>Capacity: 244Ah</u>

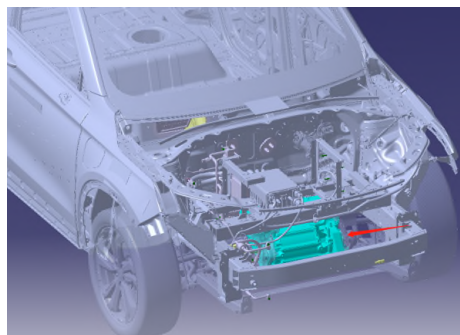
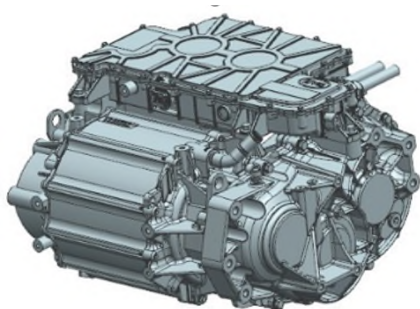

1. The 3 in 1 of electric drive is composed of three parts, including motor, motor controller and reducer

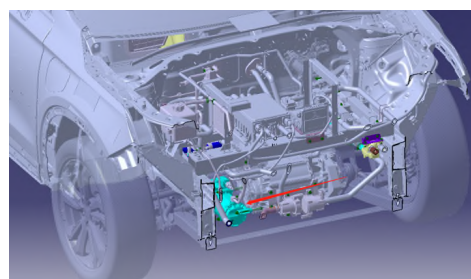
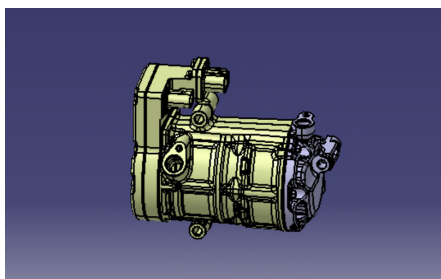

2. Compressor

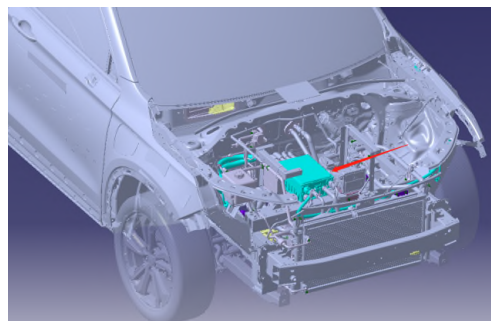
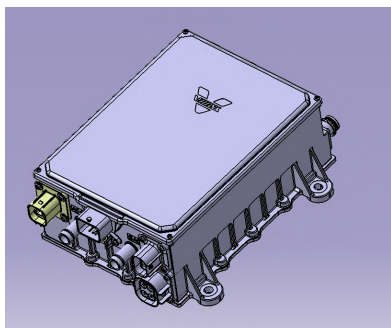

3/4/5. Option 1: CDU (DC-DC+OBC+PDU)

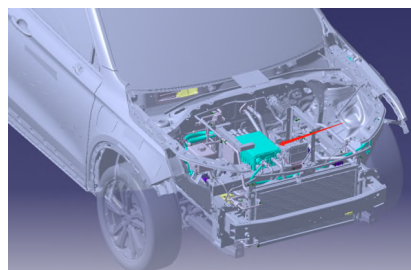
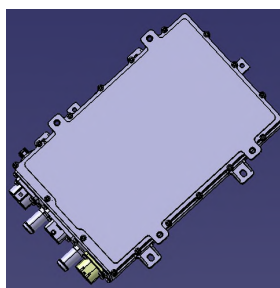

3/4/5.Option 2: DC-DC+OBC

Manufacturer : Nanjing Golden Dragon Bus Co., Ltd.
Type : NJL6470BEV500-1

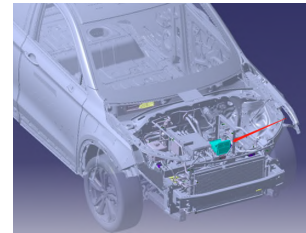
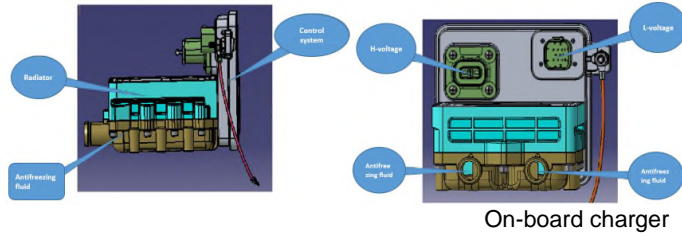

On-board charger

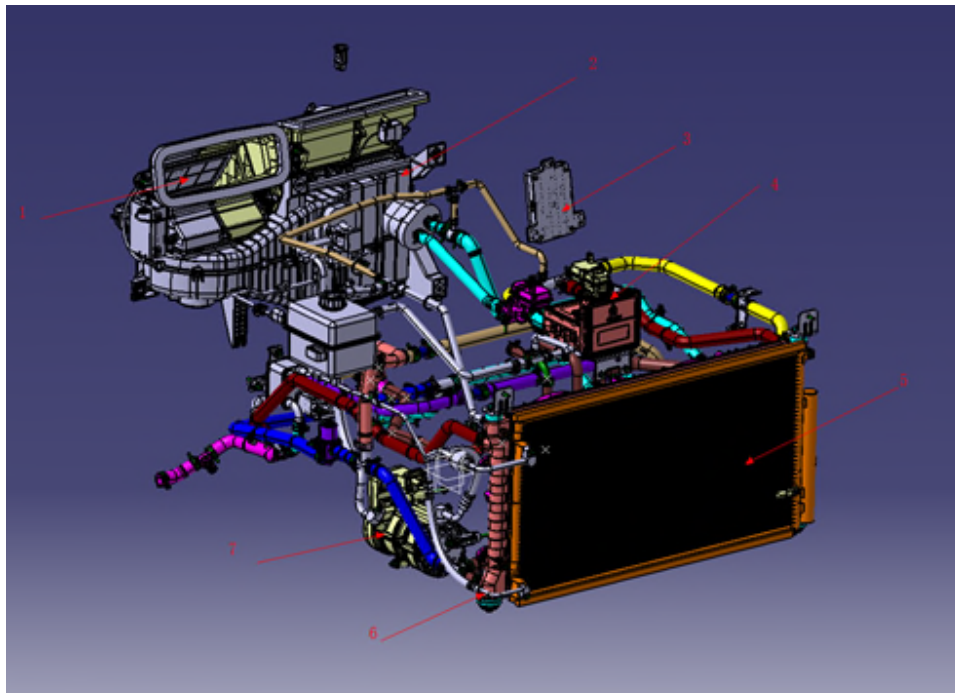

NO.↗	Part name↗	note↗
1↗	Air conditioning filter↗	↗
2↗	Air conditioning box↗	↗
3↗	Thermal Management Controller↗	↗
4↗	Air conditioning PTC Assembly↗	↗
5↗	Front-end cooling module↗	↗
6↗	Air conditioning tube↗	↗
7↗	Compressor assembly↗	↗

6. PTC

e13*2018/858*00339*02

Société Nationale de Certification et d'Homologation

Manufacturer : Nanjing Golden Dragon Bus Co., Ltd.
Type : NJL6470BEV500-1

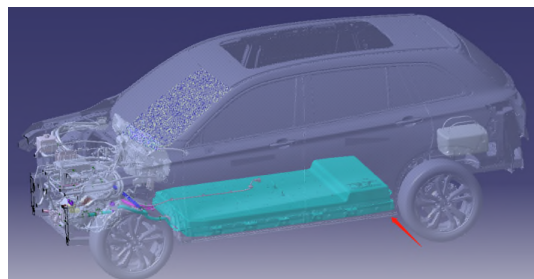

e13*2018/858*00339*02

Société Nationale de Certification et d'Homologation

Option 2:

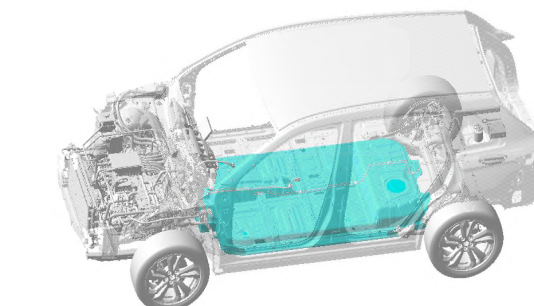
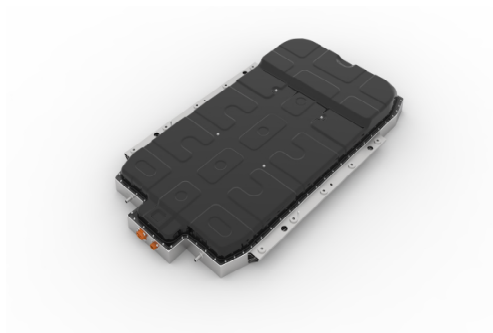

7. Battery

Annex 12 Drawing of the installation of the REESS in the vehicle

e13*2018/858*00339*02

Société Nationale de Certification et d'Homologation

Option 1 - 192 Ah

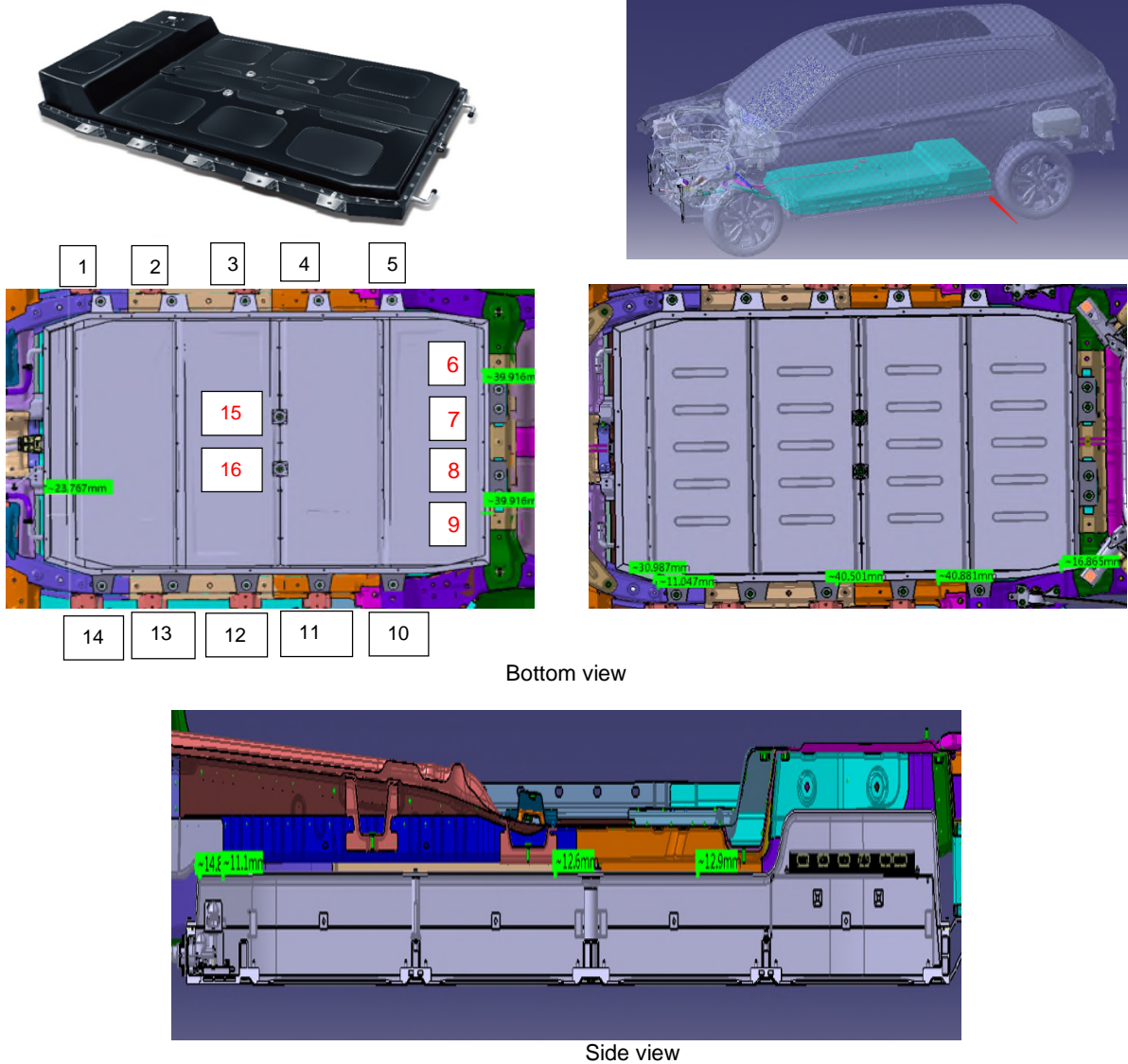

The REESS is connected to the car body using 16 bolts, of which the specifications of 14 bolts around the RESS are M12*40, and the specification of the middle two bolts are M12*170. The tightening torque is 125±5N.m.

Option 2 - 244 Ah:

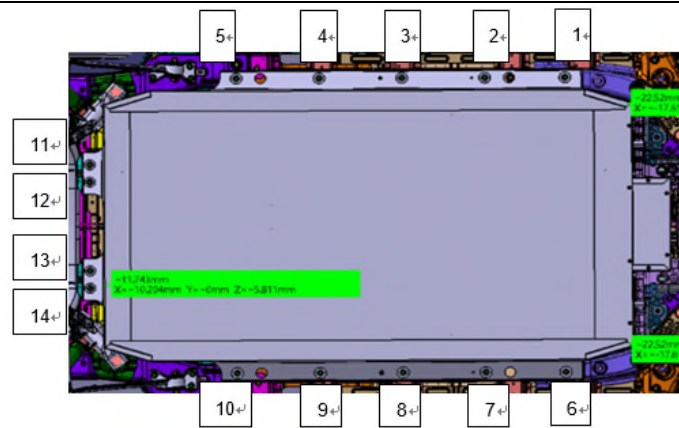
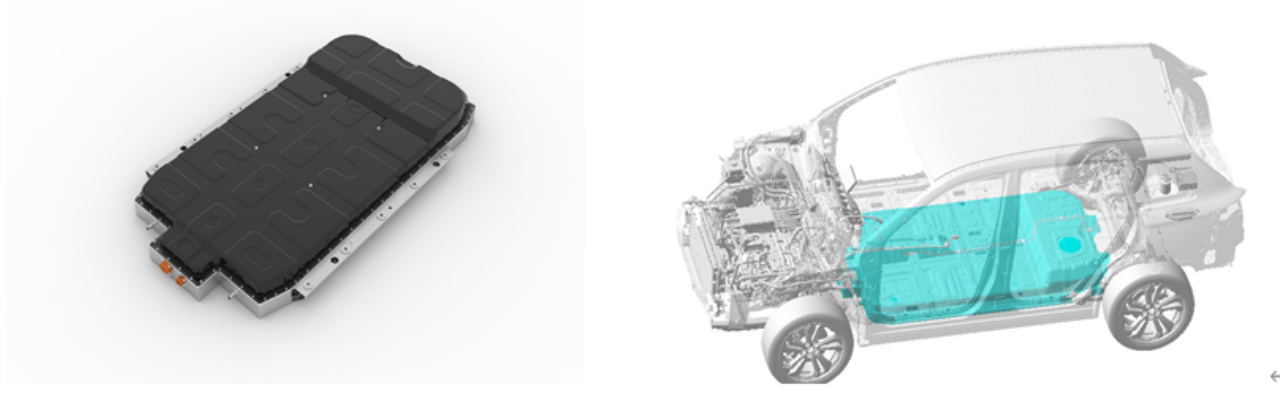

Bottom view

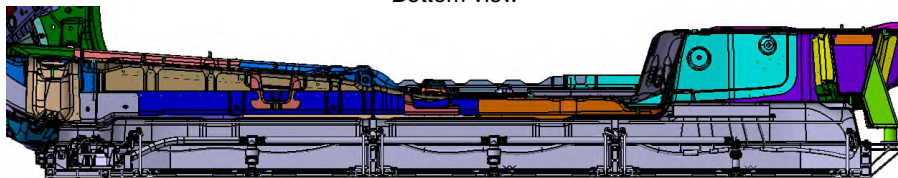

Side view

The RESS connected to the car body using 14 bolts, of which the specifications of 10 bolts around the RESS is M12*40, and the specification of the middle four bolts is M12*80, THE tightening torque is 125±5N.m.

e13*2018/858*00339*02

Société Nationale de Certification et d'Homologation

Manufacturer : Nanjing Golden Dragon Bus Co., Ltd.
Type : NJL6470BEV500-1

Annex 13 Name(s) and specimen(s) of the signature(s) of the person(s) authorized to sign CoC

Name and address of manufacturer:
Nanjing Golden Dragon Bus Co., Ltd.
No. 369, Binhuai Street, Zhetang
Town, Lishui District, Nanjing City,
Jiangsu Province, 211200, China

e13*2018/858*00339*02
Société Nationale de Certification et d'Homologation

May 06, 2022

Statement Concerning Authority of Signature on COC paper

We, Nanjing Golden Dragon Bus Co., Ltd., hereby declare that the undersigned, Mr. Liu Tao,
Quality Assurance Director, will be the authorized person to sign the COC paper of the vehicle.

Specification of signature of COC



Liu Tao / Quality Assurance Director
Nanjing Golden Dragon Bus Co., Ltd.

Manufacturer : Nanjing Golden Dragon Bus Co., Ltd.
 Type : NJL6470BEV500-1

Annex 14 CoC sample

e13*2018/858*00339*02

Société Nationale de Certification et d'Homologation

COMPLETE AND COMPLETED VEHICLES**CERTIFICATE OF CONFORMITY**

The undersigned: Mr. Liu Tao, Quality Assurance Director, hereby certifies that the vehicle:

0.1.	Make (Trade name of manufacturer):	SKYWORTH
0.2.	Type:	NJL6470BEV500-1
	- Variant:	BET1
	- Version:	AAAA5A
0.2.1.	Commercial name:	ET5
0.2.2.1.	Allowed Parameter Values for multistage type approval to use the base vehicle emission values (insert range where applicable)	Not applicable
0.2.3.	Identifiers:	
0.2.3.1.	Interpolation family's identifier:	IP-AL1A1111-LME-1
0.2.3.2.	ATCT family's identifier:	Not applicable
0.2.3.3.	PEMS family's identifier:	Not applicable
0.2.3.4.	Roadload family's identifier:	RL-AL1A1111-LME-1
0.2.3.5.	Roadload Matrix family's identifier (if applicable):	Not applicable
0.2.3.6.	Periodic regeneration family's identifier:	Not applicable
0.2.3.7.	Evaporative test family's identifier:	Not applicable
0.4.	Vehicle category:	M1
0.5.	Company name and address of manufacturer:	Nanjing Golden Dragon Bus Co., Ltd. No. 369, Binhuai Street, Zhetang Town, Lishui District, Nanjing City, Jiangsu Province, 211200, China
0.6.	Location and method of attachment of the statutory plates:	Self-adhesive label on the right side of front door frame
	Location of the vehicle identification number:	On floor frame under front passenger seat; On the statutory plate; On the upper left of dashboard
0.9.	Name and address of the manufacturer's representative (if any):	BIO AUTO SP. Z O.O. 30-015 Krakow, Swietokrzyska str, 12/323, Poland
0.10.	Vehicle identification number:	LMELBL1PXXXXXXXXXX
0.11.	Date of manufacture of the vehicle:	October 02, 2020
	conforms in all respects to the type described in approval	e13*2018/858*XXXX*02
	granted on	DD.MM.YYYY
	and can be permanently registered in Member States having	Right
	hand traffic and using	Metric
	units for the speedometer and	Metric
	units for the odometer (if applicable)	

Place: Nanchang

Date: 06.05.2022

Signature:



Position:

Quality Assurance Director

Manufacturer : Nanjing Golden Dragon Bus Co., Ltd.
Type : NJL6470BEV500-1

Vehicle category M1 (complete and completed vehicle)

General Construction Characteristics

1. Number of axles: 2 and wheels: 4
3. Powered axles (number, position, interconnection) number: 1, Front axle
3.1. Specify if the vehicle is non-automated/automated/fully automated non-automated

Main Dimensions

4. Wheelbase: 2800mm
4.1. Axle spacing: n.a.
5. Length: 4698mm.
6. Width: 1908mm
7. Height: 1696mm

Masses

13. Mass in running order: 1955kg
13.2. Actual mass of the vehicle: 1955kg
16. Technically permissible maximum masses
16.1. Technically permissible maximum laden mass: 2255kg
16.2. Technically permissible mass on each axle: Front:1175kg
Rear:1175kg
16.4. Technically permissible maximum mass of the combination: n.a.
18. Technically permissible maximum towable mass in case of: n.a.
18.1. Drawbar trailer: n.a.
18.3. Centre-axle trailer: n.a.
18.4. Un-braked trailer: n.a.
19. Technically permissible maximum static vertical mass at the coupling point: n.a.

Power Plant

20. Manufacturer of the engine: Motor -BYD Auto Industry Company Limited
21. Engine code as marked on the engine: TZ200XSJ
22. Working principle: electric motor
23. Pure electric yes/no
23.1. Class of Hybrid [electric] vehicle: yes/no.
OVC-HEV/NOVC-HEV/OVC-FCHV/NOVC-FCHV:
24. Number and arrangement of cylinders: n.a.
25. Engine capacity: n.a.
26. Fuel: Diesel/petrol/LPG/CNG-Biomethane/LNG/Ethanol/Biodiesel/Hydrogen
26.1. Mono-fuel/Di-fuel/Flex-fuel/Dual-fuel
26.2. (Dual-fuel only) Type 1A/Type 1B/Type 2A/Type 2B/Type 3B
27. Maximum power
27.1. Maximum net power (internal combustion engine): n.a.
27.3. Maximum net power(electric motor): 150 kW
27.4. Maximum 30min power (electric motor): 65 kW
28. Gearbox (type)
28.1. Gearbox ratios (to complete for vehicles with manual shift transmissions): n.a.
28.1.1. Final drive ratio (if applicable): n.a.
28.1.2. Final drive ratios (to complete if and where applicable) n.a.

Maximum Speed

29. Maximum speed: 150km/h

Axles and Suspension

30. Axle(s) track: 1:1625mm, 2:1625mm
35. Fitted tyre/wheel combination/energy efficiency class of rolling resistance coefficients (RRC) and tyre category used for CO2 determination (if applicable)
Axle1 Tyre size and category: 235/50 R19
Axle2 Tyre size and category: 235/50 R19
Rim size and wheel off set: 19x7.5J, 45mm
Rolling resistance class: B

Brakes

36. ~~Trailer brake connections mechanical/electric/pneumatic/hydraulic~~

Bodywork

38. Code for bodywork: AF
40. Colour of vehicle: blue
41. Number and configuration of doors: 5 doors: 4 side hinged doors;
1 back hinged door, open in vertical
42. Number of seating positions (including the driver): 5
42.1. Seat(s) designated for use only when the vehicle is stationary: n.a.
42.3. Number of wheelchair user accessible position: n.a.

Environmental Performances

46. Sound level
- Stationary at engine speed: n.a.
- Drive-by: 67 dB(A)
47. Exhaust emission level: AX
47.1. Parameters for emission testing of V_{ind}
47.1.1. Test mass, kg: 2021.3
47.1.2. Frontal area (m^2): n.a.
47.1.2.1. Projected frontal area of air entrance of the front grille (if applicable), cm^2 : n.a.
47.1.3. Road load coefficients
47.1.3.0. f_0 , N: 194.2
47.1.3.1. f_1 , N/(km/h): 0.187
47.1.3.2. f_2 , N/(km/h) 2 : 0.04222
47.2. Driving cycle
47.2.1. Driving Cycle class: 1/2/3a/3b
47.2.2. Downscaling factor (f_{desc}): 0
47.2.3. Capped speed: yes/no

48. Exhaust emission:

- Number of the base regulatory act and latest amending regulatory act applicable: 715/2007; 2018/1832AX
1.2. Test procedure: Type 1 (WLTP highest values) or WHSC (EURO VI): n.a.
2.2. Test procedure: WHTC (EURO VI): n.a.
48.1. Smoke corrected absorption coefficient: n.a.
48.2. Declared Maximum RDE Values (if applicable): n.a.

49. CO2 emissions/fuel consumption/electric energy consumption:

1. All power train except OVC hybrid electric vehicles(if applicable): n.a.
2. Electric range of pure electric vehicles(if applicable)

Electric range	400	km
Electric range city	456	km

3. Vehicle fitted with eco-innovation(s): yes/no
3.1. General code of the eco-innovation(s): n.a.
3.2. Total CO₂ emissions savings due to the eco-innovation(s) (repeat for each reference fuel tested): n.a.
3.2.2. WLTP savings (if applicable): n.a.
4. OVC hybrid electric vehicles (if applicable): n.a.
5. Electric range of OVC hybrid electric vehicles (if applicable): n.a.

Miscellaneous

51. For special purpose vehicles: designation in accordance with point 5 of Part A of Annex I to Regulation (EU) 2018/858 of the European Parliament and of the Council: n.a.
52. Remarks: n.a.
Additional tyre/wheel combinations: technical parameters (no reference to RR)

e13*2018/858*00339*02

Société Nationale de Certification et d'Homologation

Manufacturer : Nanjing Golden Dragon Bus Co., Ltd.
Type : NJL6470BEV500-1

Attachment RMI certificate**Manufacturer's certificate on access to vehicle OBD information and vehicle repair and maintenance information**

(Manufacturer): Nanjing Golden Dragon Bus Co., Ltd.

(Address of the manufacturer): No. 369, Binhuai Street, Zhetang Town, Lishui District, Nanjing City, Jiangsu Province, 211200, China

Certifies that

it provides access to vehicle OBD and vehicle repair and maintenance information in compliance with the provisions of:

Article 61 of Regulation (EU) No 2018/858 of the European Parliament and of the Council⁽¹⁾ and Annex X to that Regulation

with respect to the types of vehicle, system, component or separate technical unit listed in attachment to this Certificate.

The following derogations are applied: ~~Customer adaptations(*)~~ – ~~Small volume(*)~~ –.

The principal website address through which the relevant information, which is hereby certified to be in compliance with those provisions, may be accessed, are listed in an attachment to this Certificate along with the contact details of the responsible manufacturer's representative who has signed this Certificate.

Where applicable: The manufacturer hereby also certifies that he has complied with the obligation of Article 62 of Regulation (EU) No. 2018/858 to provide the relevant information concerning previous approvals of these types of vehicle no later than six months after the date of type-approval.

Done at:

e13*2018/858*00339*02
Société Nationale de Certification et d'Homologation

On: May 06, 2022



Zhu Lin, Marketing Director

Annexes:

- Annex A: Website addresses,
- Annex B: Contact details.
- Annex C: Types of vehicle, system, component or separate technical unit.

(*) Delete where not applicable

Manufacturer : Nanjing Golden Dragon Bus Co., Ltd.
Type : NJL6470BEV500-1

ANNEX A

e13*2018/858*00339*02

Société Nationale de Certification et d'Homologation

Website addresses referred to in this certificate:

Website: <https://en.skywellcv.com/>

ANNEX B

Contact details of the manufacturer's representative referred to in this certificate:

Name of the manufacturer's representative: BIO AUTO SP. Z O.O.

Address: 30-015 Krakow, Swietokrzyska str, 12/323, Poland

Email: chenquanrong@skywellcorp.com

ANNEX C

Types of vehicle, system, component or separate technical unit:

No.	Vehicle type	Remark
1	NJL6470BEV500-1	--